

3V

Polias QD de Alta Capacidade “Hi-Cap” em Estoque

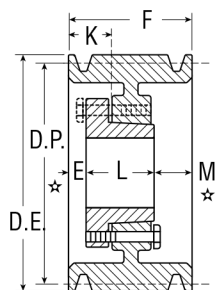

Tipo A

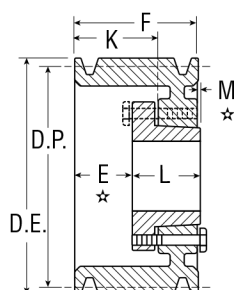

Tipo B

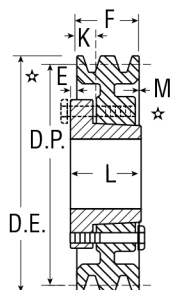

Tipo C

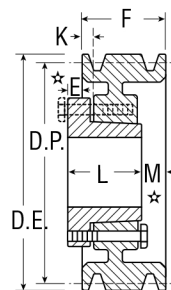

Tipo D

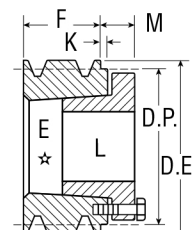

Tipo E

Nas tabelas a seguir você encontrará as dimensões das polias *Martin* para bucha QD. O tipo de polia é indicado por uma letra seguida por um número que por sua vez mostra o tipo de construção da polia, de acordo com os desenhos na próxima página.

Polias QD – 3V

1 Canal*											2 Canais								
F = 11/16											F = 1-3/32								
No. de Parte	DE	PD Passo 3V	Tipo	Bucha	Furo Máximo da Bucha	E *	K	L Compr. Total do Furo	M *	Peso sem Bucha Kg	No. de Parte	Tipo	Bucha	Furo Máximo da Bucha	E *	K	L Compr. Total do Furo	M *	Peso sem Bucha Kg
1 3V 220 JA	2.20	2.15	E-1	JA	1-1/4	9/16	7/16	1-1/16	15/16	0.3	2 3V 220 JA	E-1	JA	1-1/4	31/32	7/16	1-1/16	15/16	0.4
1 3V 235 JA	2.35	2.30	E-1	JA	1-1/4	9/16	7/16	1-1/16	15/16	0.4	2 3V 235 JA	E-1	JA	1-1/4	31/32	7/16	1-1/16	15/16	0.5
1 3V 250 JA	2.50	2.45	E-1	JA	1-1/4	9/16	7/16	1-1/16	15/16	0.4	2 3V 250 JA	E-1	JA	1-1/4	31/32	7/16	1-1/16	15/16	0.5
1 3V 265 JA	2.65	2.60	C-1	JA	1-1/4	3/8	1/8	1-1/16	—	0.4	2 3V 265 JA	D-1	JA	1-1/4	3/8	1/8	1-1/16	13/32	0.6
1 3V 280 JA	2.80	2.75	C-1	JA	1-1/4	3/8	1/8	1-1/16	—	0.4	2 3V 280 JA	D-1	JA	1-1/4	3/8	1/8	1-1/16	13/32	0.6
1 3V 300 JA	3	2.95	C-1	JA	1-1/4	3/8	1/8	1-1/16	—	0.5	2 3V 300 JA	D-1	JA	1-1/4	3/8	1/8	1-1/16	13/32	0.7
1 3V 315 JA	3.15	3.10	C-1	JA	1-1/4	3/8	1/8	1-1/16	—	0.5	2 3V 315 JA	D-1	JA	1-1/4	3/8	1/8	1-1/16	13/32	0.8
1 3V 335 JA	3.35	3.30	C-1	JA	1-11/16	3/8	1/8	1-1/16	—	0.5	2 3V 335 SH	D-1	SH	1-11/16	27/64	9/64	1-5/16	13/64	0.9
1 3V 365 SH	3.65	3.60	D-1	SH	1-11/16	9/16	—	1-5/16	1/16	0.6	2 3V 365 SH	D-1	SH	1-11/16	27/64	9/64	1-5/16	13/64	1.1
1 3V 412 SH	4.12	4.07	D-1	SH	1-11/16	9/16	—	1-5/16	1/16	0.8	2 3V 412 SH	D-1	SH	1-11/16	9/32	9/32	1-5/16	1/16	1.2
1 3V 450 SH	4.50	4.45	D-2	SH	1-11/16	9/16	—	1-5/16	1/16	1.0	2 3V 450 SH	D-1	SH	1-11/16	1/4	5/16	1-5/16	1/32	1.3
1 3V 475 SH	4.75	4.70	D-2	SH	1-11/16	9/16	—	1-5/16	1/16	1.1	2 3V 475 SH	D-1	SH	1-11/16	1/4	5/16	1-5/16	1/32	1.4
1 3V 500 SH	5	4.95	D-2	SH	1-11/16	9/16	—	1-5/16	1/16	1.3	2 3V 500 SH	D-1	SH	1-11/16	1/4	5/16	1-5/16	1/32	1.6
1 3V 530 SH	5.30	5.25	D-2	SH	1-11/16	9/16	—	1-5/16	1/16	1.5	2 3V 530 SH	D-1	SH	1-11/16	1/4	5/16	1-5/16	1/32	2.0
1 3V 560 SH	5.60	5.55	D-2	SH	1-11/16	9/16	—	1-5/16	1/16	1.5	2 3V 560 SH	D-1	SH	1-11/16	1/4	5/16	1-5/16	1/32	2.3
1 3V 600 SH	6	5.95	D-2	SH	1-11/16	9/16	—	1-5/16	1/16	1.6	2 3V 600 SH	D-1	SH	1-11/16	1/4	5/16	1-5/16	1/32	2.5
1 3V 650 SH	6.50	6.45	D-3	SH	1-11/16	9/16	—	1-5/16	1/16	1.8	2 3V 650 SDS	D-3	SDS	2	5/16	5/16	1-3/8	1/32	2.6
1 3V 690 SH	6.90	6.85	D-3	SH	1-11/16	9/16	—	1-5/16	1/16	2.0	2 3V 690 SDS	D-3	SDS	2	5/16	5/16	1-3/8	1/32	3.0
1 3V 800 SDS	8	7.95	C-3	SDS	2	5/8	—	1-3/8	—	2.5	2 3V 800 SDS	D-3	SDS	2	5/16	5/16	1-3/8	1/32	3.2
1 3V 1060 SDS	10.60	10.55	C-3	SDS	2	5/8	—	1-3/8	—	3.6	2 3V 1060 SK	C-3	SK	2-5/8	7/16	1/4	1-15/16	13/32	4.5
1 3V 1400 SK	14	13.95	C-3	SK	2-5/8	11/16	—	1-15/16	—	6.1	2 3V 1400 SK	C-3	SK	2-5/8	7/16	1/4	1-15/16	13/32	7.3
1 3V 1900 SK	19	18.95	C-3	SK	2-5/8	11/16	—	1-15/16	—	7.7	2 3V 1900 SK	C-3	SK	2-5/8	7/16	1/4	1-15/16	13/32	11.3
—	25	24.95	—	—	—	—	—	—	—	—	2 3V 2500 SF	C-3	SF	2-15/16	7/16	1/4	2-1/16	17/32	12.7

NOTA: Dimensões em polegadas, peso em kilos. O peso não inclui a bucha. Veja a página B-4 para dimensões adicionais das buchas.

* F = para a polia 1 3V 800 SDS e para a 1 3V 1060 SDS, F = 13/16" para a polia 1 3V 1400 SK e para a 1 3V 1900 SK.

★ As dimensões E e M são nominais, podem variar dependendo das tolerâncias no eixos. As polias tipo E estão unicamente usinadas para a montagem reversa.

Martin

Polias QD de Alta Capacidade “Hi-Cap” em Estoque

3V

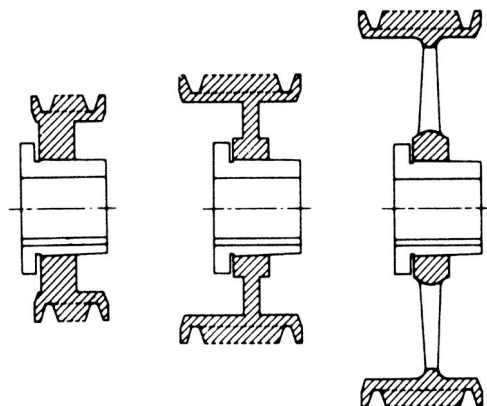
 $\frac{3}{8} \times \frac{5}{16}$
3V

1 = Sólida
2 = Alma
3 = Raios

Permita que a *Martin* lhe cote polias de fabricação especial e seus requerimentos de polias em grandes quantidades.

Polias QD – 3V

3 Canais											4 Canais									
F = 1-1/2											F = 1-29/32									
No. de Parte	DE	PD Passo 3V	Tipo	Bucha	Furo Máximo da Bucha	E ★	K	L Compr. Total do Furo	M ★	Peso sem Bucha Kg	No. de Parte	Tipo	Bucha	Furo Máximo da Bucha	E ★	K	L Compr. Total do Furo	M ★	Peso sem Bucha Kg	
3 3V 250 JA	2.50	2.45	E-1	JA	1-1/4	1-3/8	7/16	1-1/16	15/16	0.7	—	—	—	—	—	—	—	—	—	
3 3V 265 JA	2.65	2.60	D-1	JA	1-1/4	3/8	1/8	1 1/16	13/16	0.8	4 3V 265 JA	D-1	JA	1-1/4	3/8	1/8	1-1/16	1-7/32	0.6	
3 3V 280 JA	2.80	2.75	D-1	JA	1-1/4	3/8	1/8	1-1/16	13/16	0.9	4 3V 280 JA	D-1	JA	1-1/4	3/8	1/8	1-1/16	1-7/32	0.7	
3 3V 300 SH	3.00	2.95	E-1	SH	1-11/16	1-1/16	-	1-15/16	9/16	1.0	4 3V 300 SH	E-1	SH	1-11/16	1-15/32	5/16	1-5/16	7/8	0.9	
3 3V 315 SH	3.15	3.10	E-1	SH	1-11/16	1-1/16	5/16	1-5/16	7/8	1.1	4 3V 315 SH	E-1	SH	1-11/16	1-15/32	5/16	1-5/16	7/8	1.0	
3 3V 335 SH	3.35	3.30	D-1	SH	1-11/16	7/16	1/8	1-5/16	5/8	1.3	4 3V 335 SH	D-1	SH	1-11/16	7/16	1/8	1-5/16	1-1/32	1.1	
3 3V 365 SH	3.65	3.60	D-1	SH	1-11/16	7/16	1/8	1-5/16	5/8	1.4	4 3V 365 SH	D-1	SH	1-11/16	7/16	1/8	1-5/16	1-1/32	1.3	
3 3V 412 SH	4.12	4.07	A-1	SH	1-11/16	1/8	11/16	1-5/16	1/16	1.5	4 3V 412 SH	A-1	SH	1-11/16	1/4	13/16	1-5/16	11/32	1.5	
3 3V 450 SDS	4.50	4.45	A-1	SDS	2	1/16	11/16	1-3/8	1/16	1.6	4 3V 450 SDS	A-1	SDS	2	3/16	13/16	1-3/8	11/32	1.6	
3 3V 475 SDS	4.75	4.70	A-1	SDS	2	1/16	11/16	1-3/8	1/16	1.7	4 3V 475 SDS	A-1	SDS	2	3/16	13/16	1-3/8	11/32	1.8	
3 3V 500 SDS	5.00	4.95	A-1	SDS	2	1/16	11/16	1-3/8	1/16	1.8	4 3V 500 SDS	A-1	SDS	2	3/16	13/16	1-3/8	11/32	2.0	
3 3V 530 SDS	5.30	5.25	A-1	SDS	2	1/16	11/16	1-3/8	1/16	2.0	4 3V 530 SDS	A-1	SDS	2	3/16	13/16	1-3/8	11/32	2.3	
3 3V 560 SDS	5.60	5.55	A-1	SDS	2	1/16	11/16	1-3/8	1/16	2.2	4 3V 560 SDS	A-1	SDS	2	3/16	13/16	1-3/8	11/32	2.6	
3 3V 600 SDS	6.00	5.95	A-1	SDS	2	1/16	11/16	1-3/8	1/16	2.7	4 3V 600 SK	D-1	SK	2-5/8	1/16	5/8	1-15/16	1/32	3.4	
3 3V 650 SDS	6.50	6.45	A-3	SDS	2	1/16	11/16	1-3/8	1/16	2.9	4 3V 650 SK	A-1	SK	2-5/8	1/16	5/8	1-15/16	1/32	3.6	
3 3V 690 SDS	6.90	6.85	A-3	SDS	2	1/16	11/16	1-3/8	1/16	3.1	4 3V 690 SK	A-1	SK	2-5/8	1/16	5/8	1-15/16	1/32	4.5	
3 3V 800 SK	8.00	7.95	C-2	SK	2-5/8	7/16	1/4	1-15/16	—	4.8	4 3V 800 SK	D-2	SK	2-5/8	1/16	5/8	1-15/16	1/32	5.4	
3 3V 1060 SK	10.60	10.55	C-3	SK	2-5/8	7/16	1/4	1-15/16	—	5.4	4 3V 1060 SK	D-3	SK	2-5/8	1/16	5/8	1-15/16	1/32	7.3	
3 3V 1400 SK	14.00	13.95	C-3	SK	2-5/8	7/16	1/4	1-15/16	—	9.1	4 3V 1400 SK	D-3	SK	2-5/8	1/16	5/8	1-15/16	1/32	10.0	
3 3V 1900 SF	19.00	18.95	C-3	SF	2-15/16	7/16	1/4	2-1/16	1/8	15.0	4 3V 1900 SF	C-3	SF	2-15/16	1/16	5/8	2-1/16	3/32	16.8	
3 3V 2500 SF	25.00	24.95	C-3	SF	2-15/16	7/16	1/4	2-1/16	1/8	20.4	4 3V 2500 SF	C-3	SF	2-15/16	1/16	5/8	2-1/16	3/32	24.0	
3 3V 3350 SF	33.50	33.45	C-3	SF	2-15/16	7/16	1/4	2-1/16	1/8	34.0	4 3V 3350 E	C-3	E	3-1/2	3/8	1/2	2-5/8	11/32	36.3	

NOTA: Dimensões em polegadas, peso em kilos. O peso não inclui a bucha. Veja a página B-4 para dimensões adicionais das buchas.

★ As dimensões E e M são nominais, podem variar dependendo das tolerâncias no eixos. As polias tipo E estão unicamente usinadas para a montagem reversa.

3V Polias QD de Alta Capacidade

“Hi-Cap” em Estoque

Martin

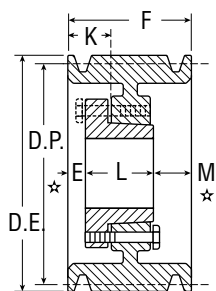

Tipo A

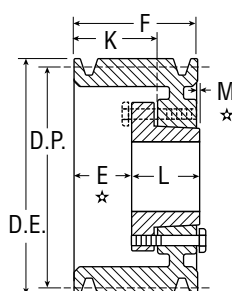

Tipo B

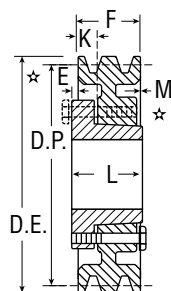

Tipo C

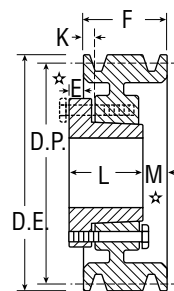

Tipo D

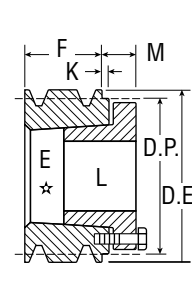

Tipo E

Polias QD – 3V

5 Canais*											6 Canais									
F = 2-5/16											F = 2-23/32									
No. de Parte	DE	PD	Tipo	Bucha	Furo Máximo da Bucha	E ★	K	L Compr. Total do Furo	M ★	Peso sem Bucha Kg	No. de Parte	Tipo	Bucha	Furo Máximo da Bucha	E ★	K	L Compr. Total do Furo	M ★	Peso sem Bucha Kg	
		Passo 3V																		
5 3V 475 SDS	4.75	4.70	A-2	SDS	2	3/16	13/16	1-3/8	3/4	2.0	6 3V 475 SK	D-1	SK	2-5/8	9/16	1/8	1-15/16	1-11/32	2.7	
5 3V 500 SDS	5.00	4.95	A-2	SDS	2	3/16	13/16	1-3/8	3/4	2.4	6 3V 500 SK	D-1	SK	2-5/8	9/16	1/8	1-15/16	1-11/32	2.9	
5 3V 530 SK	5.30	5.25	A-1	SK	2-5/8	1/4	15/16	1-15/16	1/8	2.6	6 3V 530 SK	A-1	SK	2-5/8	5/8	1-5/16	1-15/16	5/32	3.1	
5 3V 560 SK	5.60	5.55	A-1	SK	2-5/8	1/4	15/16	1-15/16	1/8	3.2	6 3V 560 SK	A-1	SK	2-5/8	5/8	1-5/16	1-15/16	5/32	3.6	
5 3V 600 SK	6.00	5.95	A-1	SK	2-5/8	1/4	15/16	1-15/16	1/8	3.8	6 3V 600 SK	A-1	SK	2-5/8	5/8	1-5/16	1-15/16	5/32	4.1	
5 3V 650 SK	6.50	6.45	A-1	SK	2-5/8	1/4	15/16	1-15/16	1/8	4.1	6 3V 650 SK	A-2	SK	2-5/8	5/8	1-5/16	1-15/16	5/32	4.5	
5 3V 690 SK	6.90	6.85	A-1	SK	2-5/8	1/4	15/16	1-15/16	1/8	5.4	6 3V 690 SK	A-2	SK	2-5/8	5/8	1-5/16	1-15/16	5/32	5.2	
5 3V 800 SK	8.00	7.95	A-2	SK	2-5/8	1/4	15/16	1-15/16	1/8	5.9	6 3V 800 SK	A-2	SK	2-5/8	3/16	7/8	1-15/16	19/32	7.7	
5 3V 1060 SK	10.60	10.55	A-3	SK	2-5/8	1/4	15/16	1-15/16	1/8	7.7	6 3V 1060 SF	A-2	SF	2-15/16	3/16	7/8	2-1/16	15/32	11.3	
5 3V 1400 SF	14.00	13.95	A-3	SF	2-15/16	3/16	7/8	2-1/16	1/16	12.2	6 3V 1400 SF	A-3	SF	2-15/16	3/16	7/8	2-1/16	15/32	15.4	
5 3V 1900 SF	19.00	18.95	A-3	SF	2-15/16	3/16	7/8	2-1/16	1/16	18.1	6 3V 1900 E	B-3	E	3-1/2	1/8	1	2-5/8	1/32	20.4	
5 3V 2500 E	25.00	24.95	C-3	E	3-1/2	1/4	5/8	2-5/8	1/16	31.3	6 3V 2500 E	B-3	E	3-1/2	1/8	1	2-5/8	1/32	34.0	
5 3V 3350 E	33.50	33.45	C-3	E	3-1/2	1/4	5/8	2-5/8	1/16	44.0	6 3V 3350 E	B-3	E	3-1/2	1/8	1	2-5/8	1/32	44.5	

Polias QD – 3V

8 Canais*											10 Canais										
F = 3-17/32											F = 4-11/32										
No. de Parte	DE	PD	Tipo	Bucha	Furo Máximo da Bucha	E ★	K	L Compr. Total do Furo	M ★	Peso sem Bucha Kg	No. de Parte	Tipo	Bucha	Furo Máximo da Bucha	E ★	K	L Compr. Total do Furo	M ★	Peso sem Bucha Kg		
		Passo 3V																			
8 3V 475 SK	4.75	4.70	D-1	SK	2-5/8	9/16	1/8	1-15/16	25/32	2.7	10 3V 475 SK	D-1	SK	2-5/8	9/16	1/8	1-15/16	2-31/32	3.2		
8 3V 500 SK	5.00	4.95	D-1	SK	2-5/8	9/16	1/8	1-15/16	2-5/32	3.1	10 3V 500 SK	D-1	SK	2-5/8	9/16	1/8	1-15/16	2-31/32	3.9		
8 3V 530 SK	5.30	5.25	A-1	SK	2-5/8	5/8	1-5/16	1-15/16	31/32	3.5	10 3V 530 SK	A-1	SK	2-5/8	3/4	1-7/16	1-15/16	1-21/32	4.1		
8 3V 560 SK	5.60	5.55	A-1	SK	2-5/8	5/8	1-5/16	1-15/16	31/32	4.1	10 3V 560 SK	A-1	SK	2-5/8	3/4	1-7/16	1-15/16	1-21/32	4.5		
8 3V 600 SK	6.00	5.95	A-1	SK	2-5/8	5/8	1-5/16	1-15/16	31/32	4.5	10 3V 600 SK	A-1	SK	2-5/8	3/4	1-7/16	1-15/16	1-21/32	5.0		
8 3V 650 SK	6.50	6.45	A-2	SK	2-5/8	5/8	1-5/16	1-15/16	31/32	5.9	10 3V 650 SK	A-2	SK	2-5/8	3/4	1-7/16	1-15/16	1-21/32	6.4		
8 3V 690 SK	6.90	6.85	A-2	SK	2-5/8	5/8	1-5/16	1-15/16	31/32	6.4	10 3V 690 SK	A-2	SK	2-5/8	3/4	1-7/16	1-15/16	1-21/32	7.3		
8 3V 800 SF	8.00	7.95	A-1	SF	2-15/16	7/16	1-1/8	2-1/16	1-1/32	9.1	10 3V 800 SF	A-1	SF	2-15/16	13/16	1-1/2	2-1/16	1-15/32	10.0		
8 3V 1060 SF	10.60	10.55	A-2	SF	2-15/16	7/16	1-1/8	2-1/16	1-1/32	12.7	10 3V 1060 E	A-2	E	3-1/2	3/8	1-1/4	2-5/8	1-11/32	15.0		
8 3V 1400 E	14.00	13.95	A-3	E	3-1/2	3/8	1-1/4	2-5/8	17/32	18.1	10 3V 1400 E	A-3	E	3-1/2	3/8	1-1/4	2-5/8	1-11/32	19.5		
8 3V 1900 E	19.00	18.95	A-3	E	3-1/2	3/8	1-1/4	2-5/8	17/32	28.1	10 3V 1900 E	A-3	E	3-1/2	3/8	1-1/4	2-5/8	1-11/32	29.9		
8 3V 2500 E	25.00	24.95	A-3	E	3-1/2	3/8	1-1/4	2-5/8	17/32	39.5	10 3V 2500 F	A-3	F	3-15/16	5/16	1-5/16	3-5/8	13/32	44.5		
8 3V 3350 F	33.50	33.45	B-3	F	3-15/16	1/16	1-1/16	3-5/8	5/32	68.9	10 3V 3350 F	A-3	F	3-15/16	5/16	1-5/16	3-5/8	13/32	80.7		

NOTA: Dimensões em polegadas, peso em kilos. O peso não inclui a bucha. Veja a página B-4 para dimensões adicionais das buchas.

★As dimensões E e M são nominais, podem variar dependendo das tolerâncias no eixos. As polias tipo E estão unicamente usinadas para a montagem reversa.

Martin

Polias QD de Alta Capacidade “Hi-Cap” em Estoque

5V

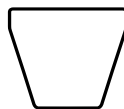

5/8 x 17/32

5V

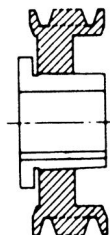

1 = Sólida

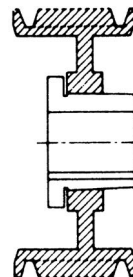

2 = Alma

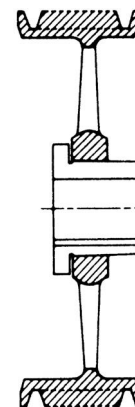

3 = Raios

Polias QD – 5V

2 Canais F = 1-11/16										3 Canais F = 2-3/8									
No. de Parte	DE	PD Passo 5V	Tipo	Bucha	Furo Máximo da Bucha	E ★	K	L Compr. Total do Furo	M ★	Peso sem Bucha Kg	No. de Parte	Tipo	Bucha	Furo Máximo da Bucha	E ★	K	L Compr. Total do Furo	M ★	Peso sem Bucha Kg
2 5V 440 SH	4.40	4.30	A-1	SH	1-11/16	5/16	7/8	1-5/16	1/16	1.8	3 5V 440 SDS	E-1	SDS	2	1-5/8	—	1-3/8	5/8	2.5
2 5V 465 SDS	4.65	4.55	E-1	SDS	2	15/16	—	1-3/8	5/8	2.0	3 5V 465 SDS	E-1	SDS	2	1-5/8	—	1-3/8	5/8	2.9
2 5V 490 SDS	4.90	4.80	A-1	SDS	2	1/16	11/16	1-3/8	1/4	2.3	3 5V 490 SDS	A-1	SDS	2	7/16	1-1/16	1-3/8	9/16	3.2
2 5V 520 SDS	5.20	5.10	A-1	SDS	2	1/16	11/16	1-3/8	1/4	2.5	3 5V 520 SDS	A-1	SDS	2	7/16	1-1/16	1-3/8	9/16	3.4
2 5V 550 SDS	5.50	5.40	A-1	SDS	2	1/16	11/16	1-3/8	1/4	2.7	3 5V 550 SDS	A-1	SDS	2	7/16	1-1/16	1-3/8	9/16	3.6
2 5V 590 SDS	5.90	5.80	A-1	SDS	2	1/16	11/16	1-3/8	1/4	3.2	3 5V 590 SDS	A-1	SDS	2	7/16	1-1/16	1-3/8	9/16	3.9
2 5V 630 SK	6.30	6.20	C-1	SK	2-5/8	1/4	7/16	1-15/16	—	3.6	3 5V 630 SK	A-1	SK	2-5/8	3/8	1-1/16	1-15/16	1/16	5.0
2 5V 670 SK	6.70	6.60	C-1	SK	2-5/8	1/4	7/16	1-15/16	—	4.5	3 5V 670 SK	A-1	SK	2-5/8	3/8	1-1/16	1-15/16	1/16	5.2
2 5V 710 SK	7.10	7.00	C-1	SK	2-5/8	1/4	7/16	1-15/16	—	5.0	3 5V 710 SF	A-1	SF	2-15/16	5/16	1	2-1/16	—	5.9
2 5V 750 SK	7.50	7.40	C-1	SK	2-5/8	1/4	7/16	1-15/16	—	5.9	3 5V 750 SF	A-1	SF	2-15/16	5/16	1	2-1/16	—	6.4
2 5V 800 SK	8.00	7.90	C-1	SK	2-5/8	1/4	7/16	1-15/16	—	6.4	3 5V 800 SF	A-1	SF	2-15/16	5/16	1	2-1/16	—	6.8
2 5V 850 SK	8.50	8.40	C-1	SK	2-5/8	1/4	7/16	1-15/16	—	6.8	3 5V 850 SF	A-1	SF	2-15/16	5/16	1	2-1/16	—	7.3
2 5V 900 SK	9.00	8.90	C-2	SK	2-5/8	1/4	7/16	1-15/16	—	7.3	3 5V 900 SF	A-2	SF	2-15/16	5/16	1	2-1/16	—	7.7
2 5V 925 SK	9.25	9.15	C-2	SK	2-5/8	1/4	7/16	1-15/16	—	7.5	3 5V 925 SF	A-2	SF	2-15/16	5/16	1	2-1/16	—	8.2
2 5V 975 SK	9.75	9.65	C-3	SK	2-5/8	1/4	7/16	1-15/16	—	7.7	3 5V 975 SF	A-2	SF	2-15/16	5/16	1	2-1/16	—	8.6
2 5V 1030 SK	10.30	10.20	C-3	SK	2-5/8	1/4	7/16	1-15/16	—	8.2	3 5V 1030 SF	A-2	SF	2-15/16	5/16	1	2-1/16	—	10.0
2 5V 1090 SK	10.90	10.80	C-3	SK	2-5/8	1/4	7/16	1-15/16	—	8.6	3 5V 1090 SF	A-2	SF	2-15/16	5/16	1	2-1/16	—	11.3
2 5V 1130 SK	11.30	11.20	C-3	SK	2-5/8	1/4	7/16	1-15/16	—	8.8	3 5V 1130 SF	A-2	SF	2-15/16	5/16	1	2-1/16	—	11.3
2 5V 1180 SK	11.80	11.70	C-3	SK	2-5/8	1/4	7/16	1-15/16	—	9.1	3 5V 1180 SF	A-2	SF	2-15/16	5/16	1	2-1/16	—	13.2
2 5V 1250 SF	12.50	12.40	C-3	SF	2-15/16	1/4	7/16	2-1/16	1/8	11.3	3 5V 1250 E	C-2	E	3-1/2	1/8	3/4	2-5/8	1/8	14.5
2 5V 1320 SF	13.20	13.10	C-3	SF	2-15/16	1/4	7/16	2-1/16	1/8	12.2	3 5V 1320 E	C-3	E	3-1/2	1/8	3/4	2-5/8	1/8	17.2
2 5V 1400 SF	14.00	13.90	C-3	SF	2-15/16	1/4	7/16	2-1/16	1/8	12.7	3 5V 1400 E	C-3	E	3-1/2	1/8	3/4	2-5/8	1/8	19.5
2 5V 1500 SF	15.00	14.90	C-3	SF	2-15/16	1/4	7/16	2-1/16	1/8	13.6	3 5V 1500 E	C-3	E	3-1/2	1/8	3/4	2-5/8	1/8	20.0
2 5V 1600 SF	16.00	15.90	C-3	SF	2-15/16	1/4	7/16	2-1/16	1/8	15.4	3 5V 1600 E	C-3	E	3-1/2	1/8	3/4	2-5/8	1/8	20.9
2 5V 1870 SF	18.70	18.60	C-3	SF	2-15/16	1/4	7/16	2-1/16	1/8	22.2	3 5V 1870 E	C-3	E	3-1/2	1/8	3/4	2-5/8	1/8	27.2
2 5V 2120 SF	21.20	21.10	C-3	SF	2-15/16	1/4	7/16	2-1/16	1/8	22.7	3 5V 2120 E	C-3	E	3-1/2	1/8	3/4	2-5/8	1/8	30.8
2 5V 2360 E	23.60	23.50	C-3	E	3-1/2	5/8	1/4	2-5/8	5/16	32.7	3 5V 2360 E	C-3	E	3-1/2	1/8	3/4	2-5/8	1/8	36.3
2 5V 2800 E	28.00	27.90	C-3	E	3-1/2	5/8	1/4	2-5/8	5/16	36.3	3 5V 2800 E	C-3	E	3-1/2	1/8	3/4	2-5/8	1/8	41.7
—	31.50	31.40	—	—	—	—	—	—	—	—	3 5V 3150 F	C-3	F	3-15/16	7/16	9/16	3-5/8	13/16	61.7
—	37.50	37.40	—	—	—	—	—	—	—	—	3 5V 3750 F	C-3	F	3-15/16	7/16	9/16	3-5/8	13/16	70.8
—	50.00	49.90	—	—	—	—	—	—	—	—	3 5V 5000 F	C-3	F	3-15/16	7/16	9/16	3-5/8	13/16	95.3

NOTA: Dimensões em polegadas, peso em kilos. O peso não inclui a bucha. Veja a página B-4 para dimensões adicionais das buchas.

★ As dimensões E e M são nominais, podem variar dependendo das tolerâncias no eixos. As polias tipo E estão unicamente usinadas para a montagem reversa.

5V

Polias QD de Alta Capacidade “Hi-Cap” em Estoque

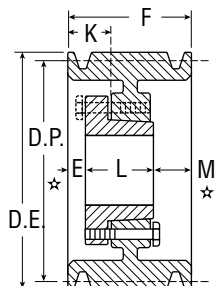
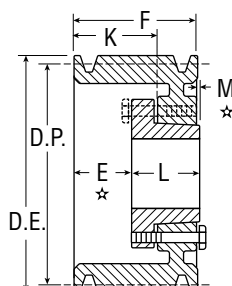
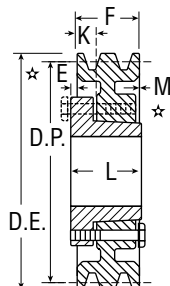
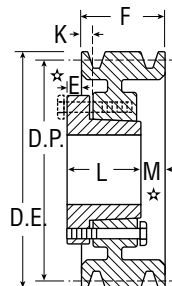
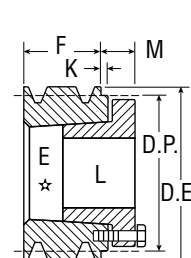
Martin**Tipo A****Tipo B****Tipo C****Tipo D****Tipo E**

Polias QD – 5V

4 Canais											5 Canais										
F = 3-1/16											F = 3-3/4										
No. de Parte	DE	PD Passo 5V	Tipo	Bucha	Furo Máximo da Bucha	E ★	K	L Compr. Total do Furo	M ★	Peso sem Bucha Kg	No. de Parte	Tipo	Bucha	Furo Máximo da Bucha	E ★	K	L Compr. Total do Furo	M ★	Peso sem Bucha Kg		
*4 5V 440 SD	4.40	4.30	E-1	SD	2	1-7/8	—	1-13/16	5/8	2.3	*5 5V 440 SD	E-1	SD	2	2-9/16	-	1-13/16	5/8	2.7		
*4 5V 465 SD	4.65	4.55	E-1	SD	2	1-7/8	—	1-13/16	5/8	2.7	*5 5V 465 SD	E-1	SD	2	2-9/16	1-5/16	1-13/16	5/8	3.2		
*4 5V 490 SD	4.90	4.80	A-1	SD	2	11/16	1-5/16	1-13/16	9/16	3.2	*5 5V 490 SD	A-1	SD	2	11/16	1-5/16	1-13/16	1-1/4	3.6		
*4 5V 520 SD	5.20	5.10	A-1	SD	2	11/16	1-5/16	1-13/16	9/16	3.6	*5 5V 520 SD	A-1	SD	2	11/16	1-5/16	1-13/16	1-1/4	4.1		
*4 5V 550 SD	5.50	5.40	A-1	SD	2	11/16	1-5/16	1-13/16	9/16	4.1	*5 5V 550 SD	A-1	SD	2	11/16	1-5/16	1-13/16	1-1/4	4.5		
*4 5V 590 SD	5.90	5.80	A-1	SD	2	11/16	1-5/16	1-13/16	9/16	4.9	*5 5V 590 SK	A-1	SK	2-5/8	5/8	1-5/16	1-15/16	1-3/16	5.0		
*4 5V 630 SK	6.30	6.20	A-1	SK	2-5/8	5/8	1-5/16	1-15/16	1/2	5.4	*5 5V 630 SK	A-1	SK	2-5/8	5/8	1-5/16	1-15/16	1-3/16	5.4		
*4 5V 670 SK	6.70	6.60	A-1	SK	2-5/8	5/8	1-5/16	1-15/16	1/2	6.4	*5 5V 670 SF	A-1	SF	2-15/16	5/8	1-5/16	2-1/16	1-1/16	5.9		
*4 5V 710 SF	7.10	7.00	A-1	SF	2-15/16	3/8	1-1/16	2-1/16	5/8	6.8	5 5V 710 SF	A-1	SF	2-15/16	11/16	1-3/8	2-1/16	1	6.4		
*4 5V 750 SF	7.50	7.40	A-1	SF	2-15/16	3/8	1-1/16	2-1/16	5/8	7.3	5 5V 750 SF	A-1	SF	2-15/16	11/16	1-3/8	2-1/16	1	7.3		
4 5V 800 E	8.00	7.90	B-1	E	3-1/2	9/16	1-7/16	2-5/8	1/8	8.6	5 5V 800 E	A-1	E	3-1/2	7/8	1-3/4	2-5/8	1/4	8.6		
4 5V 850 E	8.50	8.40	B-1	E	3-1/2	9/16	1-7/16	2-5/8	1/8	10.4	5 5V 850 E	A-1	E	3-1/2	7/8	1-3/4	2-5/8	1/4	10.0		
4 5V 900 E	9.00	8.90	B-1	E	3-1/2	9/16	1-7/16	2-5/8	1/8	11.3	5 5V 900 E	A-1	E	3-1/2	7/8	1-3/4	2-5/8	1/4	11.8		
4 5V 925 E	9.25	9.15	B-1	E	3-1/2	9/16	1-7/16	2-5/8	1/8	11.8	5 5V 925 E	A-1	E	3-1/2	7/8	1-3/4	2-5/8	1/4	12.7		
4 5V 975 E	9.75	9.65	B-1	E	3-1/2	9/16	1-7/16	2-5/8	1/8	12.7	5 5V 975 E	A-1	E	3-1/2	7/8	1-3/4	2-5/8	1/4	13.6		
4 5V 1030 E	10.30	10.20	B-1	E	3-1/2	9/16	1-7/16	2-5/8	1/8	13.6	5 5V 1030 E	A-1	E	3-1/2	7/8	1-3/4	2-5/8	1/4	15.0		
4 5V 1090 E	10.90	10.80	B-2	E	3-1/2	9/16	1-7/16	2-5/8	1/8	17.7	5 5V 1090 E	A-1	E	3-1/2	7/8	1-3/4	2-5/8	1/4	18.6		
4 5V 1130 E	11.30	11.20	B-2	E	3-1/2	9/16	1-7/16	2-5/8	1/8	18.1	5 5V 1130 E	A-1	E	3-1/2	7/8	1-3/4	2-5/8	1/4	19.1		
4 5V 1180 E	11.80	11.70	B-2	E	3-1/2	9/16	1-7/16	2-5/8	1/8	18.6	5 5V 1180 E	A-1	E	3-1/2	7/8	1-3/4	2-5/8	1/4	20.0		
4 5V 1250 E	12.50	12.40	B-3	E	3-1/2	9/16	1-7/16	2-5/8	1/8	19.5	5 5V 1250 E	A-3	E	3-1/2	7/8	1-3/4	2-5/8	1/4	20.4		
4 5V 1320 E	13.20	13.10	B-3	E	3-1/2	9/16	1-7/16	2-5/8	1/8	20.4	5 5V 1320 E	A-3	E	3-1/2	7/8	1-3/4	2-5/8	1/4	20.9		
4 5V 1400 E	14.00	13.90	B-3	E	3-1/2	9/16	1-7/16	2-5/8	1/8	20.9	5 5V 1400 E	A-3	E	3-1/2	7/8	1-3/4	2-5/8	1/4	21.3		
4 5V 1500 E	15.00	14.90	B-3	E	3-1/2	9/16	1-7/16	2-5/8	1/8	21.3	5 5V 1500 E	A-3	E	3-1/2	7/8	1-3/4	2-5/8	1/4	24.0		
4 5V 1600 E	16.00	15.90	B-3	E	3-1/2	9/16	1-7/16	2-5/8	1/8	22.2	5 5V 1600 E	A-3	E	3-1/2	7/8	1-3/4	2-5/8	1/4	25.4		
4 5V 1870 E	18.70	18.60	A-3	E	3-1/2	3/8	1-1/4	2-5/8	1/16	32.2	5 5V 1870 F	B-3	F	3-15/16	5/16	1-5/16	3-5/8	3/16	43.5		
4 5V 2120 E	21.20	21.10	A-3	E	3-1/2	3/8	1-1/4	2-5/8	1/16	32.7	5 5V 2120 F	B-3	F	3-15/16	5/16	1-5/16	3-5/8	3/16	44.5		
4 5V 2360 F	23.60	23.50	C-3	F	3-15/16	1/8	7/8	3-5/8	7/16	50.3	5 5V 2360 F	B-3	F	3-15/16	5/16	1-5/16	3-5/8	3/16	54.4		
4 5V 2800 F	28.00	27.90	C-3	F	3-15/16	1/8	7/8	3-5/8	7/16	53.5	5 5V 2800 F	B-3	F	3-15/16	5/16	1-5/16	3-5/8	3/16	61.2		
4 5V 3150 F	31.50	31.40	C-3	F	3-15/16	1/8	7/8	3-5/8	7/16	66.5	5 5V 3150 J	C-3	J	4-1/2	3/16	1	4-1/2	9/16	85.3		
4 5V 3750 F	37.50	37.40	C-3	F	3-15/16	1/8	7/8	3-5/8	7/16	80.7	5 5V 3750 J	C-3	J	4-1/2	3/16	1	4-1/2	9/16	101.6		
4 5V 5000 J	50.00	49.90	C-3	J	4-1/2	1/2	11/16	4-1/2	15/16	120.7	5 5V 5000 J	C-3	J	4-1/2	3/16	1	4-1/2	9/16	139.7		

NOTA: Dimensões em polegadas, peso em kilos. O peso não inclui a bucha. Veja a página B-4 para dimensões adicionais das buchas.

★ As dimensões E e M são nominais, podem variar dependendo das tolerâncias no eixos. As polias tipo E estão unicamente usinadas para a montagem reversa.

Martin

Polias QD de Alta Capacidade “Hi-Cap” em Estoque

5V

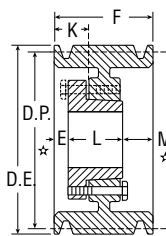

Tipo A

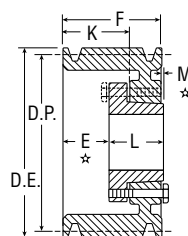

Tipo B

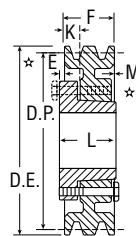

Tipo C

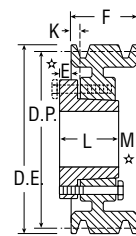

Tipo D

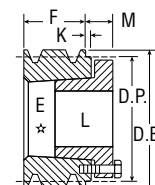

Tipo E

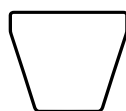

5V

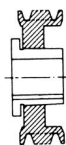

1 = Sólida

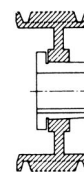

2 = Alma

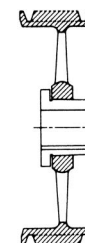

3 = Raios

Polias QD – 5V

6 Canais F = 4-7/16										7 Canais F = 5-7/8									
No. de Parte	DE	PD Passo 5V	Tipo	Bucha	Furo Máximo da Bucha	E ★	K	L Compr. Total do Furo	M ★	Peso sem Bucha Kg	No. de Parte	Tipo	Bucha	Furo Máximo da Bucha	E ★	K	L Compr. Total do Furo	M ★	Peso sem Bucha Kg
*6 5V 440 SD	4.40	4.30	E-1	SD	2	3-1/4	—	1-13/16	5/8	3.2	—	—	—	—	—	—	—	—	—
*6 5V 465 SD	4.65	4.55	E-1	SD	2	3-1/4	—	1-13/16	5/8	3.5	—	—	—	—	—	—	—	—	—
*6 5V 490 SD	4.90	4.80	A-1	SD	2	11/16	1-5/16	1-13/16	1-15/16	4.1	—	—	—	—	—	—	—	—	—
*6 5V 520 SD	5.20	5.10	A-1	SD	2	11/16	1-5/16	1-13/16	1-15/16	4.9	—	—	—	—	—	—	—	—	—
*6 5V 550 SD	5.50	5.40	A-1	SD	2	11/16	1-5/16	1-13/16	1-15/16	5.1	—	—	—	—	—	—	—	—	—
*6 5V 590 SK	5.90	5.80	A-1	SK	2-5/8	5/8	1-5/16	1-15/16	1-7/8	5.4	—	—	—	—	—	—	—	—	—
*6 5V 630 SK	6.30	6.20	A-1	SK	2-5/8	5/8	1-5/16	1-15/16	1-7/8	5.9	—	—	—	—	—	—	—	—	—
*6 5V 670 SF	6.70	6.60	A-1	SF	2-15/16	15/16	1-5/8	2-1/16	1-7/16	6.4	—	—	—	—	—	—	—	—	—
6 5V 710 SF	7.10	7.00	A-1	SF	2-15/16	15/16	1-5/8	2-1/16	1-7/16	6.8	7 5V 710 SF	A-1	SF	2-15/16	15/16	1-5/8	2-1/16	2-1/8	7.7
6 5V 750 SF	7.50	7.40	A-1	SF	2-15/16	15/16	1-5/8	2-1/16	1-7/16	7.7	7 5V 750 SF	A-1	SF	2-15/16	15/16	1-5/8	2-1/16	2-1/8	8.6
6 5V 800 E	8.00	7.90	A-1	E	3-1/2	1-1/8	2	2-5/8	11/16	9.1	7 5V 800 E	A-1	E	3-1/2	1-1/8	2	2-5/8	1-3/8	10.0
6 5V 850 E	8.50	8.40	A-1	E	3-1/2	1-1/8	2	2-5/8	11/16	11.3	7 5V 850 E	A-1	E	3-1/2	1-1/8	2	2-5/8	1-3/8	11.8
6 5V 900 E	9.00	8.90	A-1	E	3-1/2	1-1/8	2	2-5/8	11/16	12.7	7 5V 900 E	A-1	E	3-1/2	1-1/8	2	2-5/8	1-3/8	13.2
6 5V 925 E	9.25	9.15	A-1	E	3-1/2	1-1/8	2	2-5/8	11/16	13.2	7 5V 925 E	A-1	E	3-1/2	1-1/8	2	2-5/8	1-3/8	15.0
6 5V 975 E	9.75	9.65	A-1	E	3-1/2	1-1/8	2	2-5/8	11/16	14.1	7 5V 975 E	A-1	E	3-1/2	1-1/8	2	2-5/8	1-3/8	16.8
6 5V 1030 E	10.30	10.20	A-1	E	3-1/2	1-1/8	2	2-5/8	11/16	15.0	7 5V 1030 F	B-1	F	3-15/16	1-5/8	2-9/16	3-5/8	1/8	22.2
6 5V 1090 E	10.90	10.80	A-1	E	3-1/2	1-1/8	2	2-5/8	11/16	17.2	7 5V 1090 F	B-1	F	3-15/16	1-5/8	2-9/16	3-5/8	1/8	25.4
6 5V 1130 E	11.30	11.20	A-1	E	3-1/2	1-1/8	2	2-5/8	11/16	18.6	7 5V 1130 F	B-1	F	3-15/16	1-5/8	2-9/16	3-5/8	1/8	27.7
6 5V 1180 E	11.80	11.70	A-1	E	3-1/2	1-1/8	2	2-5/8	11/16	19.5	7 5V 1180 F	B-2	F	3-15/16	1-5/8	2-9/16	3-5/8	1/8	25.4
6 5V 1250 F	12.50	12.40	B-3	F	3-15/16	1-1/16	2-1/16	3-5/8	1/4	20.4	7 5V 1250 F	B-3	F	3-15/16	1-5/8	2-9/16	3-5/8	1/8	24.0
6 5V 1320 F	13.20	13.10	B-3	F	3-15/16	1-1/16	2-1/16	3-5/8	1/4	21.8	7 5V 1320 F	B-3	F	3-15/16	1-5/8	2-9/16	3-5/8	1/8	23.6
6 5V 1400 F	14.00	13.90	B-3	F	3-15/16	1-1/16	2-1/16	3-5/8	1/4	26.8	7 5V 1400 F	B-3	F	3-15/16	1-5/8	2-9/16	3-5/8	1/8	28.1
6 5V 1500 F	15.00	14.90	B-3	F	3-15/16	1-1/16	2-1/16	3-5/8	1/4	29.0	7 5V 1500 F	B-3	F	3-15/16	1-5/8	2-9/16	3-5/8	1/8	30.4
6 5V 1600 F	16.00	15.90	B-3	F	3-15/16	1-1/16	2-1/16	3-5/8	1/4	30.8	7 5V 1600 F	B-3	F	3-15/16	1-5/8	2-9/16	3-5/8	1/8	34.9
6 5V 1870 F	18.70	18.60	A-3	F	3-15/16	5/16	1-5/16	3-5/8	1/2	38.0	7 5V 1870 F	A-3	F	3-15/16	3/8	1-5/16	3-5/8	1-1/8	44.9
6 5V 2120 F	21.20	21.10	A-3	F	3-15/16	5/16	1-5/16	3-5/8	1/2	49.9	7 5V 2120 J	C-3	J	4-1/2	3/16	1-5/16	4-1/2	7/16	62.6
6 5V 2360 J	23.60	23.50	B-3	J	4-1/2	1/8	1-5/16	4-1/2	3/16	67.1	7 5V 2330 J	C-3	J	4-1/2	3/16	1-5/16	4-1/2	7/16	78.9
6 5V 2800 J	28.00	27.90	B-3	J	4-1/2	1/8	1-5/16	4-1/2	3/16	76.7	7 5V 2800 J	C-3	J	4-1/2	3/16	1-5/16	4-1/2	7/16	76.7
6 5V 3150 J	31.50	31.40	B-3	J	4-1/2	1/8	1-5/16	4-1/2	3/16	93.4	7 5V 3150 J	C-3	J	4-1/2	3/16	1-5/16	4-1/2	7/16	109.3
6 5V 3750 J	37.50	37.40	B-3	J	4-1/2	1/8	1-5/16	4-1/2	3/16	109.3	7 5V 3750 M	C-3	M	5-1/2	9/16	1-15/16	6-3/4	2-3/16	136.1
6 5V 5000 M	50.00	49.90	C-3	M	5-1/2	1/8	1/2	6-3/4	1-3/8	176.0	7 5V 5000 M	C-3	M	5-1/2	7/16	1/2	6-3/4	3/4	185.1

NOTA: Dimensões em polegadas, peso em kilos. O peso não inclui a bucha. Veja a página B-4 para dimensões adicionais das buchas.

★ As dimensões E e M são nominais, podem variar dependendo das tolerâncias no eixos. As polias tipo E estão unicamente usinadas para a montagem reversa.

5V Polias QD de Alta Capacidade “Hi-Cap” em Estoque



Polias QD – 5V

8 Canais										9 Canais									
F = 5-13/16										F = 6-1/2									
No. de Parte	DE	PD Passo 5V	Tipo	Bucha	Furo Máximo da Bucha	E ★	K	L Compr. Total do Furo	M ★	Peso sem Bucha Kg	No. de Parte	Tipo	Buje	Furo Máximo da Bucha	E ★	K	L Compr. Total do Furo	M ★	Peso sem Bucha Kg
8 5V 710 SF	7.10	7.00	A-1	SF	2-15/16	1-7/16	2-1/8	2-1/16	2-5/16	8.6	—	—	—	—	—	—	—	—	—
8 5V 750 SF	7.5	7.40	A-1	SF	2-15/16	1-7/16	2-1/8	2-1/16	2-5/16	9.1	—	—	—	—	—	—	—	—	—
8 5V 800 E	8.00	7.90	A-1	E	3-1/2	1-5/8	2-1/2	2-5/8	1-9/16	11.3	9 5V 800 E	A-1	E	3-1/2	1-5/8	2-1/2	2-5/8	2-1/4	11.8
8 5V 850 E	8.50	8.40	A-1	E	3-1/2	1-5/8	2-1/2	2-5/8	1-9/16	13.2	9 5V 850 E	A-1	E	3-1/2	1-5/8	2-1/2	2-5/8	2-1/4	13.6
8 5V 900 E	9.00	8.90	A-1	E	3-1/2	1-5/8	2-1/2	2-5/8	1-9/16	14.5	9 5V 900 E	A-1	F	3-15/16	1-5/8	2-1/2	2-5/8	2-1/4	15.0
8 5V 925 F	9.25	9.15	A-1	F	3-1/2	1-9/16	2-9/16	3-5/8	5/8	17.7	9 5V 925 F	A-1	F	3-15/16	1-5/8	2-9/16	3-5/8	1-1/4	15.0
8 5V 975 F	9.75	9.65	A-1	F	3-15/16	1-9/16	2-9/16	3-5/8	5/8	19.1	9 5V 975 F	A-1	F	3-15/16	1-5/8	2-9/16	3-5/8	1-1/4	20.4
8 5V 1030 F	10.30	10.20	A-1	F	3-15/16	1-9/16	2-9/16	3-5/8	5/8	23.6	9 5V 1030 F	A-1	F	3-15/16	1-5/8	2-9/16	3-5/8	1-1/4	24.5
8 5V 1090 F	10.90	10.80	A-1	F	3-15/16	1-9/16	2-9/16	3-5/8	5/8	26.8	9 5V 1090 F	A-1	F	3-15/16	1-5/8	2-9/16	3-5/8	1-1/4	28.1
8 5V 1130 F	11.30	11.20	A-1	F	3-15/16	1-9/16	2-9/16	3-5/8	5/8	28.1	9 5V 1130 F	A-1	F	3-15/16	1-5/8	2-9/16	3-5/8	1-1/4	30.4
8 5V 1180 F	11.80	11.70	A-1	F	3-15/16	1-9/16	2-9/16	3-5/8	5/8	29.0	9 5V 1180 F	A-1	F	3-15/16	1-5/8	2-9/16	3-5/8	1-1/4	33.1
8 5V 1250 F	12.50	12.40	A-3	F	3-15/16	1-9/16	2-9/16	3-5/8	5/8	29.9	9 5V 1250 F	A-3	F	3-15/16	1-5/8	2-9/16	3-5/8	1-1/4	27.7
8 5V 1320 F	13.20	13.10	A-3	F	3-15/16	1-9/16	2-9/16	3-5/8	5/8	30.8	9 5V 1320 F	A-3	F	3-15/16	1-5/8	2-9/16	3-5/8	1-1/4	27.2
8 5V 1400 F	14.00	13.90	A-3	F	3-15/16	1-9/16	2-9/16	3-5/8	5/8	31.8	9 5V 1400 F	A-3	F	3-15/16	1-5/8	2-9/16	3-5/8	1-1/4	31.8
8 5V 1500 F	15.00	14.90	A-3	F	3-15/16	1-9/16	2-9/16	3-5/8	5/8	33.1	9 5V 1500 J	B-2	J	4-1/2	2-7/16	3-9/16	4-1/2	7/16	43.1
8 5V 1600 F	16.00	15.90	A-3	F	3-15/16	1-9/16	1-9/16	3-5/8	5/8	40.4	9 5V 1600 J	B-2	J	4-1/2	2-7/16	3-9/16	4-1/2	7/16	46.7
8 5V 1870 J	18.70	18.60	A-3	J	4-1/2	3/8	1-9/16	4-1/2	15/16	59.9	9 5V 1870 J	A-3	J	4-1/2	7/16	1-9/16	4-1/2	1-9/16	63.5
8 5V 2120 J	21.20	21.10	A-3	J	4-1/2	3/8	1-9/16	4-1/2	15/16	68.0	9 5V 2120 J	A-3	J	4-1/2	7/16	1-9/16	4-1/2	1-9/16	68.9
8 5V 2360 J	23.60	23.50	A-3	J	4-1/2	3/8	1-9/16	4-1/2	15/16	73.5	9 5V 2360 M	A-3	J	4-1/2	7/16	1-9/16	4-1/2	1-9/16	79.8
8 5V 2800 J	28.00	27.90	A-3	J	4-1/2	3/8	1-9/16	4-1/2	15/16	86.6	9 5V 2800 M	B-3	M	5-1/2	9/16	1-15/16	6-3/4	13/16	120.2
8 5V 3150 M	31.50	31.40	B-3	M	5-1/2	1/2	1-15/16	6-3/4	1-7/16	135.2	9 5V 3150 M	B-3	M	5-1/2	9/16	1-15/16	6-3/4	13/16	142.0
8 5V 3750 M	37.50	37.40	B-3	M	5-1/2	1/2	1-15/16	6-3/4	1-7/16	144.7	9 5V 3750 M	B-3	M	5-1/2	9/16	1-15/16	6-3/4	13/16	185.5
8 5V 5000 M	50.00	49.90	B-3	M	5-1/2	1/2	1-15/16	6-3/4	1-7/16	225.4	9 5V 5000 M	B-3	M	5-1/2	9/16	1-15/16	6-3/4	13/16	219.1

10 Canais										
F = 7-3/16										
No. de Parte	DE	PD	Tipo	Bucha	Furo Máximo da Bucha	E ★	K	L Compr. Total do Furo	M ★	Peso sem Bucha Kg
		Passo 5V								
10 5V 800 E	8.00	7.90	A-1	E	3-1/2	2-3/8	3-1/4	2-5/8	2-3/16	12.2
10 5V 850 E	8.5	8.40	A-1	E	3-1/2	2-3/8	3-1/4	2-5/8	2-3/16	14.5
10 5V 900 F	9.00	8.90	A-1	F	3-15/16	2-5/16	3-5/16	3-5/8	1-1/4	18.6
10 5V 925 F	9.25	9.15	A-1	F	3-15/16	2-5/16	3-5/16	3-5/8	1-1/4	21.3
10 5V 975 F	9.75	9.65	A-1	F	3-15/16	2-5/16	3-5/16	3-5/8	1-1/4	26.3
10 5V 1030 F	10.30	10.20	A-1	F	3-15/16	2-5/16	3-5/16	3-5/8	1-1/4	29.9
10 5V 1090 F	10.90	10.80	A-1	F	3-15/16	2-5/16	3-5/16	3-5/8	1-1/4	34.0
10 5V 1130 F	11.30	11.20	A-1	F	3-15/16	2-5/16	3-5/16	3-5/8	1-1/4	35.8
10 5V 1180 F	11.80	11.70	A-1	F	3-15/16	2-5/16	3-5/16	3-5/8	1-1/4	36.3
10 5V 1250 J	12.50	12.40	A-1	J	4-1/2	2-3/8	3-9/16	4-1/2	5/16	37.2
10 5V 1320 J	13.20	13.10	A-1	J	4-1/2	2-3/8	3-9/16	4-1/2	5/16	38.6
10 5V 1400 J	14.00	13.90	A-1	J	4-1/2	2-3/8	3-9/16	4-1/2	5/16	40.8
10 5V 1500 J	15.00	14.90	A-2	J	4-1/2	2-3/8	3-9/16	4-1/2	5/16	41.7
10 5V 1600 J	16.00	15.90	A-1	J	4-1/2	2-3/8	3-9/16	4-1/2	5/16	46.3
10 5V 1870 J	18.70	18.60	A-3	J	4-1/2	3/8	1-9/16	4-1/2	2-3/16	68.0
10 5V 2120 J	21.20	21.10	A-3	J	4-1/2	3/8	1-9/16	4-1/2	2-3/16	74.4
10 5V 2360 M	23.60	23.50	B-3	M	5-1/2	1/2	1-15/16	6-3/4	1/16	117.0
10 5V 2800 M	28.00	27.90	B-3	M	5-1/2	1/2	1-15/16	6-3/4	1/16	126.1
10 5V 3150 M	31.50	31.40	B-3	M	5-1/2	1/2	1-15/16	6-3/4	1/16	144.2
10 5V 3750 M	37.50	37.40	B-3	M	5-1/2	1/2	1-15/16	6-3/4	1/16	154.2
10 5V 5000 M	50.00	49.90	B-3	M	5-1/2	1/2	1-15/16	6-3/4	1/16	244.0

NOTA: Dimensões em polegadas, peso em kilos. O peso não inclui a bucha. Veja a página B-4 para dimensões adicionais das buchas.

★ As dimensões E e M são nominais, podem variar dependendo das tolerâncias no eixos. As polias tipo E estão unicamente usinadas para a montagem reversa.



Polias QD de Alta Capacidade “Hi-Cap” em Estoque

8V

Polias QD – 8V

4 Canais											5 Canais								
F = 4-7/8											F = 6								
No. de Parte	DE	PD Passo 5V	Tipo	Bucha	Furo Máximo da Bucha	E ★	K	L Compr. Total do Furo	M ★	Peso sem Bucha Kg	No. de parte	Tipo	Bucha	Furo Máximo da Bucha	E ★	K	L Compr. Total do Furo	M ★	Peso sem Bucha Kg
4 8V 1250 F	12.50	12.30	A-1	F	3-15/16	3/16	1-3/16	3-5/8	1-1/16	28.6	5 8V 1250 F	A-1	F	3-15/16	1-5/16	2-5/16	3-5/8	1-1/16	30.8
4 8V 1320 F	13.20	13.00	A-2	F	3-15/16	3/16	1-3/16	3-5/8	1-1/16	29.9	5 8V 1320 F	A-2	F	3-15/16	1-5/16	2-5/16	3-5/8	1-1/16	34.0
4 8V 1400 F	14.00	13.80	A-2	F	3-15/16	3/16	1-3/16	3-5/8	1-1/16	31.8	5 8V 1400 F	A-2	F	3-15/16	1-5/16	2-5/16	3-5/8	1-1/16	35.4
4 8V 1500 F	15.00	14.80	A-2	F	3-15/16	3/16	1-3/16	3-5/8	1-1/16	33.6	5 8V 1500 F	A-2	F	3-15/16	1-5/16	2-5/16	3-5/8	1-1/16	42.6
4 8V 1600 F	16.00	15.80	A-2	F	3-15/16	3/16	1-3/16	3-5/8	1-1/16	37.2	5 8V 1600 F	A-2	F	3-15/16	1-5/16	2-5/16	3-5/8	1-1/16	45.8
4 8V 1700 F	17.00	16.80	A-3	F	3-15/16	3/16	1-3/16	3-5/8	1-1/16	42.6	5 8V 1700 J	A-3	J	4-1/2	13/16	2	4-1/2	11/16	50.3
4 8V 1800 F	18.00	17.80	A-3	F	3-15/16	3/16	1-3/16	3-5/8	1-1/16	44.9	5 8V 1800 J	A-3	J	4-1/2	13/16	2	4-1/2	11/16	59.0
4 8V 1900 F	19.00	18.80	A-3	F	3-15/16	3/16	1-3/16	3-5/8	1-1/16	47.6	5 8V 1900 J	A-3	J	4-1/2	13/16	2	4-1/2	11/16	61.2
4 8V 2000 J	20.00	19.80	A-3	J	4-1/2	1/4	1-7/16	4-1/2	1/8	64.0	5 8V 2000 J	A-3	J	4-1/2	13/16	2	4-1/2	11/16	68.9
4 8V 2120 J	21.20	21.00	A-3	J	4-1/2	1/4	1-7/16	4-1/2	1/8	68.0	5 8V 2120 J	A-3	J	4-1/2	13/16	2	4-1/2	11/16	69.4
4 8V 2240 J	22.40	22.20	A-3	J	4-1/2	1/4	1-7/16	4-1/2	1/8	80.3	5 8V 2240 M	B-3	M	5-1/2	1/2	1-15/16	6-3/4	1-1/4	101.2
4 8V 2480 M	24.80	24.60	C-3	M	5-1/2	5/8	13/16	6-3/4	1-1/4	101.2	5 8V 2480 M	B-3	M	5-1/2	1/2	1-15/16	6-3/4	1-1/4	106.1
4 8V 3000 M	30.00	29.80	C-3	M	5-1/2	5/8	13/16	6-3/4	1-1/4	129.3	5 8V 3000 M	B-3	M	5-1/2	1/2	1-15/16	6-3/4	1-1/4	133.4
4 8V 3550 M	35.50	35.30	C-3	M	5-1/2	5/8	13/16	6-3/4	1-1/4	138.3	5 8V 3550 M	B-3	M	5-1/2	1/2	1-15/16	6-3/4	1-1/4	147.4
4 8V 4000 M	40.00	39.80	C-3	M	5-1/2	5/8	13/16	6-3/4	1-1/4	161.0	5 8V 4000 M	B-3	M	5-1/2	1/2	1-15/16	6-3/4	1-1/4	195.0
4 8V 4450 M	44.50	44.30	C-3	M	5-1/2	5/8	13/16	6-3/4	1-1/4	167.4	5 8V 4450 N	C-3	N	6	13/16	15/16	8-1/8	1-5/16	220.0
4 8V 5300 M	53.00	52.80	C-3	M	5-1/2	3/8	13/16	6-3/4	1-1/4	216.8	5 8V 5300 N	C-3	N	6	13/16	15/16	8-1/8	1-5/16	304.8

6 Canais											8 Canais								
F = 7-1/8											F = 9-3/8								
No. de Parte	DE	DP Passo 8V	Tipo	Bucha	Furo Máximo da Bucha	E ★	K	L Compr. Total do Furo	M ★	Peso sem Bucha Kg	No. de parte	Tipo	Bucha	Furo Máximo da Bucha	E ★	K	L Compr. Total do Furo	M ★	Peso sem Bucha Kg
6 8V 1250 F	12.50	12.30	A-1	F	3-15/16	1-5/16	2-5/16	3-5/8	2-3/16	39.0	8 8V 1250 J	A-1	J	4-1/2	2-3/8	3-9/16	4-1/2	2-1/2	49.0
6 8V 1320 F	13.20	13.00	A-1	F	3-15/16	1-5/16	2-5/16	3-5/8	2-3/16	42.6	8 8V 1320 J	A-1	J	4-1/2	2-3/8	3-9/16	4-1/2	2-1/2	53.5
6 8V 1400 F	14.00	13.80	A-1	F	3-15/16	1-5/16	2-5/16	3-5/8	2-3/16	49.0	8 8V 1400 J	A-1	J	4-1/2	2-3/8	3-9/16	4-1/2	2-1/2	59.4
6 8V 1500 J	15.00	14.80	A-1	J	4-1/2	1-3/8	2-9/16	4-1/2	1-1/4	62.6	8 8V 1500 J	A-1	J	4-1/2	2-3/8	3-9/16	4-1/2	2-1/2	68.5
6 8V 1600 J	16.00	15.80	A-1	J	4-1/2	1-3/8	2-9/16	4-1/2	1-1/4	64.4	8 8V 1600 J	A-1	J	4-1/2	2-3/8	3-9/16	4-1/2	2-1/2	70.3
6 8V 1700 J	17.00	16.80	A-2	J	4-1/2	1-3/8	2-9/16	4-1/2	1-1/4	65.3	8 8V 1700 M	A-2	M	5-1/2	2-1/2	3-15/16	6-3/4	1/8	85.3
6 8V 1800 J	18.00	17.80	A-2	J	4-1/2	1-3/8	2-9/16	4-1/2	1-1/4	72.6	8 8V 1800 M	A-2	M	5-1/2	2-1/2	3-15/16	6-3/4	1/8	91.6
6 8V 1900 J	19.00	18.80	A-2	J	4-1/2	1-3/8	2-9/16	4-1/2	1-1/4	78.0	8 8V 1900 M	A-2	M	5-1/2	2-1/2	3-15/16	6-3/4	1/8	100.2
6 8V 2000 M	20.00	19.80	B-2	M	5-1/2	1-1/2	2-15/16	6-3/4	1-1/8	92.5	8 8V 2000 M	A-2	M	5-1/2	2-1/2	3-15/16	6-3/4	1/8	107.0
6 8V 2120 M	21.20	21.00	B-2	M	5-1/2	1-1/2	2-15/16	6-3/4	1-1/8	102.5	8 8V 2120 M	A-2	M	5-1/2	2-1/2	3-15/16	6-3/4	1/8	121.1
6 8V 2240 M	22.40	22.20	B-3	M	5-1/2	1-1/2	2-15/16	6-3/4	1-1/8	106.6	8 8V 2240 M	A-3	M	5-1/2	2-1/2	3-15/16	6-3/4	1/8	128.8
6 8V 2480 M	24.80	24.60	B-3	M	5-1/2	1/2	1-15/16	6-3/4	1/8	111.6	8 8V 2480 N	A-2	N	6	1/2	2-1/4	8-1/8	3/4	189.6
6 8V 3000 M	30.00	29.80	B-3	M	6	1/2	1-15/16	6-3/4	1/8	138.8	8 8V 3000 N	A-3	N	6	1/2	2-1/4	8-1/8	3/4	202.8
6 8V 3550 N	35.50	35.30	C-3	N	6	5/8	1-1/8	8-1/8	3/8	211.4	8 8V 3550 N	A-3	N	6	1/2	2-1/4	8-1/8	3/4	250.8
6 8V 4000 N	40.00	39.80	C-3	N	6	5/8	1-1/8	8-1/8	3/8	248.6	8 8V 4000 N	A-3	N	6	1/2	2-1/4	8-1/8	3/4	293.9
6 8V 4450 N	44.50	44.30	C-3	N	6	5/8	1-1/8	8-1/8	3/8	267.6	8 8V 4450 P	B-3	P	6-3/4	5/8	2-5/8	9-3/8	5/8	308.0
6 8V 5300 N	53.00	52.80	C-3	N	6	5/8	1-1/8	8-1/8	3/8	298.5	8 8V 5300 P	B-3	P	6-3/4	5/8	2-5/8	9-3/8	5/8	429.1
6 8V 6300 P	63.00	62.80	C-3	P	6-3/4	-	2	9-3/8	1-7/8	390.1	8 8V 6300 P	B-3	P	6-3/4	5/8	2-5/8	9-3/8	1/4	622.3
6 8V 7100 P	71.00	70.80	B-3	P	6-3/4	-	2	9-3/8	1-7/8	577.0	8 8V 7100 W	C-3	W	8-1/2	7/8	1-3/8	11-3/8	3/4	762.0

NOTA: Dimensões em polegadas, peso em kilos. O peso não inclui a bucha. Veja a página B-4 para dimensões adicionais das buchas.

★ As dimensões E e M são nominais, podem variar dependendo das tolerâncias no eixos. As polias tipo E estão unicamente usinadas para a montagem reversa.

8V

Polias QD de Alta Capacidade “Hi-Cap” em Estoque

Martin

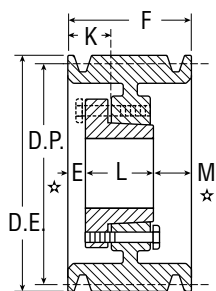

Tipo A

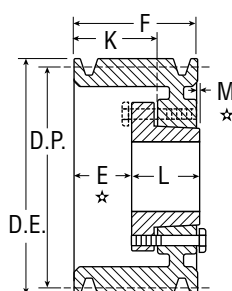

Tipo B

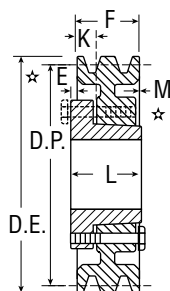

Tipo C

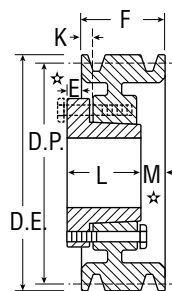

Tipo D

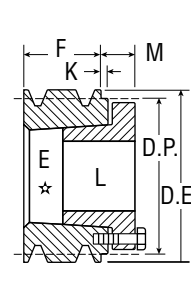

Tipo E

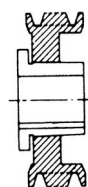

1 = Sólida

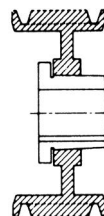

2 = Alma

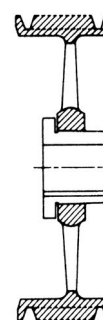

3 = Raios

Polias QD – 8V

10 Canais F = 11-5/8										12 Canais F = 14									
No. de Parte	DE	PD Passo 8V	Tipo	Bucha	Furo Máximo da Bucha	E *	K	L Compr. Total do Furo	M *	Peso sem Bucha Kg	No. de Parte	Tipo	Bucha	Furo Máximo da Bucha	E *	K	L Compr. Total do Furo	M *	Peso sem Bucha Kg
10 8V 1250 J	12.50	12.30	A-1	J	4-1/2	2-3/8	3-9/16	4-1/2	4-3/4	55.3	12 8V 1250 M	A-1	M	5-1/2	2-1/2	3-15/16	6-3/4	4-5/8	73.0
10 8V 1320 J	13.20	13.00	A-1	J	4-1/2	2-3/8	3-9/16	4-1/2	4-3/4	63.5	12 8V 1320 M	A-1	M	5-1/2	2-1/2	3-15/16	6-3/4	4-5/8	83.9
10 8V 1400 J	14.00	13.80	A-1	J	4-1/2	2-3/8	3-9/16	4-1/2	4-3/4	68.9	12 8V 1400 M	A-1	M	5-1/2	2-1/2	3-15/16	6-3/4	4-5/8	95.7
10 8V 1500 M	15.00	14.80	A-1	M	5-1/2	2-1/2	3-15/16	6-3/4	2-3/8	96.2	12 8V 1500 M	A-1	M	5-1/2	2-1/2	3-15/16	6-3/4	4-5/8	106.1
10 8V 1600 M	16.00	15.80	A-1	M	5-1/2	2-1/2	3-15/16	6-3/4	2-3/8	99.3	12 8V 1600 M	A-1	M	5-1/2	2-1/2	3-15/16	6-3/4	4-5/8	129.3
10 8V 1700 M	17.00	16.80	A-2	M	5-1/2	2-1/2	3-15/16	6-3/4	2-3/8	103.4	12 8V 1700 M	A-1	M	5-1/2	2-1/2	3-15/16	6-3/4	4-5/8	147.0
10 8V 1800 M	18.00	17.80	A-2	M	5-1/2	2-1/2	3-15/16	6-3/4	2-3/8	107.0	12 8V 1800 M	A-2	M	5-1/2	2-1/2	3-15/16	6-3/4	4-5/8	149.7
10 8V 1900 M	19.00	18.80	A-2	M	5-1/2	2-1/2	3-15/16	6-3/4	2-3/8	117.9	12 8V 1900 N	A-2	N	6	1/2	2-1/4	8-1/8	5-1/4	153.3
10 8V 2000 M	20.00	19.80	A-2	M	5-1/2	2-1/2	3-15/16	6-3/4	2-3/8	127.0	12 8V 2000 N	A-2	N	6	1/2	2-1/4	8-1/8	5-1/4	165.6
10 8V 2120 M	21.20	21.00	A-2	M	5-1/2	2-1/2	3-15/16	6-3/4	2-3/8	135.2	12 8V 2120 N	A-2	N	6	1/2	2-1/4	8-1/8	5-1/4	173.3
10 8V 2240 N	22.40	22.20	A-2	N	6	1/2	2-1/4	8-1/8	3	166.0	12 8V 2240 N	A-2	N	6	1/2	2-1/4	8-1/8	5-1/4	181.0
10 8V 2480 N	24.80	24.60	A-2	N	6	1/2	2-1/4	8-1/8	3	205.9	12 8V 2480 N	A-2	N	6	1/2	2-1/4	8-1/8	5-1/4	205.9
10 8V 3000 N	30.00	29.80	A-3	N	6	1/2	2-1/4	8-1/8	3	212.3	12 8V 3000 P	A-3	P	6-3/4	5/8	2-5/8	9-3/8	3-7/8	274.4
10 8V 3550 P	35.50	35.30	A-3	P	6-3/4	5/8	2-5/8	9-3/8	1-5/8	355.6	12 8V 3550 P	A-3	P	6-3/4	5/8	2-5/8	9-3/8	3-7/8	320.2
10 8V 4000 P	40.00	39.80	A-3	P	6-3/4	5/8	2-5/8	9-3/8	1-5/8	374.7	12 8V 4000 P	A-3	P	6-3/4	5/8	2-5/8	9-3/8	3-7/8	347.5
10 8V 4450 P	44.50	44.30	A-3	P	6-3/4	5/8	2-5/8	9-3/8	1-5/8	451.8	12 8V 4450 P	A-3	P	6-3/4	5/8	2-5/8	9-3/8	3-7/8	412.8
10 8V 5300 P	53.00	52.80	A-3	P	6-3/4	5/8	2-5/8	9-3/8	1/4	458.1	12 8V 5300 W	A-3	W	8-1/2	5/8	2-7/8	11-3/8	2-1/4	604.6
10 8V 6300 W	63.00	62.80	A-3	W	8-1/2	5/8	2-7/8	11-3/8	—	654.5	12 8V 6300 W	A-3	W	8-1/2	5/8	2-7/8	11-3/8	2-1/4	806.0
10 8V 7100 W	71.00	70.80	A-3	W	8-1/2	5/8	2-7/8	11-3/8	—	835.5	12 8V 7100 W	A-3	W	8-1/2	5/8	2-7/8	11-3/8	2-1/4	908.1

NOTA: Dimensões em polegadas, peso em kilos. O peso não inclui a bucha. Veja a página B-4 para dimensões adicionais das buchas.

★ As dimensões E e M são nominais, podem variar dependendo das tolerâncias no eixos. As polias tipo E estão unicamente usinadas para a montagem reversa.

Martin

Polias QD Convencionais de Canal Combinado em Estoque

A-B

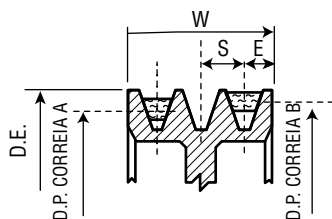

Dimensões de Canais Combinados

Seção da Correia	E	S	D.E.
AB	1/2	3/4	DP B + .35

$$W = S(N-1) + 2E$$

$$N = \text{No. de Canais}$$

O desenho mostra a posição das correias "A" e "B" no canal.

O desenho mostra a posição das correias "A" e "B" no canal quando forem utilizadas com polias QD



$$\frac{1}{2} \times \frac{5}{16}$$

A

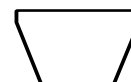

$$\frac{21}{32} \times \frac{13}{32}$$

B

Polias QD – A-B

1 Canal											2 Canais									
F = 7/8 a 1 B 64 SDS / F = 1 outros											F = 1-3/4									
No. de Parte	DP		DE	Tipo	Buchas	Furo Máximo da Bucha	E ★	K	L Compr. Total do Furo	M ★	Peso sem Bucha Kg	No. de parte	Tipo	Buchas	Furo Máximo da Bucha	E ★	K	L Compr. Total do Furo	M ★	Peso sem Bucha Kg
	Correia A	Correia B																		
1 B 34 SH	3.0	3.4	3.75	D-1	SH	1-11/16	9/16	—	1-5/16	1/8	0.5	2 B 34 SH	E-1	SH	1-11/16	1	—	1-5/16	9/16	0.5
1 B 36 SH	3.2	3.6	3.95	D-1	SH	1-11/16	9/16	—	1-5/16	1/8	0.6	2 B 36 SH	D-1	SH	1-11/16	3/8	3/16	1-5/16	13/16	0.6
1 B 38 SH	3.4	3.8	4.15	D-1	SH	1-11/16	9/16	—	1-5/16	1/8	0.7	2 B 38 SH	D-1	SH	1-11/16	3/8	3/16	1-5/16	13/16	0.8
1 B 40 SH	3.6	4.0	4.35	C-1	SH	1-11/16	1/4	5/16	1-5/16	3/16	0.8	2 B 40 SH	A-1	SH	1-11/16	1/8	11/16	1-5/16	5/16	0.9
1 B 42 SH	3.8	4.2	4.55	C-1	SH	1-11/16	1/4	5/16	1-5/16	3/16	0.9	2 B 42 SH	A-1	SH	1-11/16	1/8	11/16	1-5/16	5/16	1.1
1 B 44 SH	4.0	4.4	4.75	C-1	SH	1-11/16	1/4	5/16	1-5/16	3/16	1.0	2 B 44 SH	A-1	SH	1-11/16	1/8	11/16	1-5/16	5/16	1.3
1 B 46 SDS	4.2	4.6	4.95	C-1	SDS	2	5/16	5/16	1-3/8	3/16	1.1	2 B 46 SDS	A-2	SDS	2	1/16	11/16	1-3/8	5/16	2.2
1 B 48 SDS	4.4	4.8	5.15	C-1	SDS	2	5/16	5/16	1-3/8	3/16	1.2	2 B 48 SDS	A-2	SDS	2	1/16	11/16	1-3/8	5/16	2.3
1 B 50 SDS	4.6	5.0	5.35	C-1	SDS	2	5/16	5/16	1-3/8	3/16	1.4	2 B 50 SDS	A-2	SDS	2	1/16	11/16	1-3/8	5/16	2.4
1 B 52 SDS	4.8	5.2	5.55	C-1	SDS	2	5/16	5/16	1-3/8	3/16	1.5	2 B 52 SDS	A-2	SDS	2	1/16	11/16	1-3/8	5/16	2.5
1 B 54 SDS	5.0	5.4	5.75	C-1	SDS	2	5/16	5/16	1-3/8	3/16	1.7	2 B 54 SDS	A-1	SDS	2	1/16	11/16	1-3/8	5/16	2.6
1 B 56 SDS	5.2	5.6	5.95	C-1	SDS	2	5/16	5/16	1-3/8	3/16	1.8	2 B 56 SDS	A-2	SDS	2	1/16	11/16	1-3/8	5/16	2.7
1 B 58 SDS	5.4	5.8	6.15	C-1	SDS	2	5/16	5/16	1-3/8	3/16	2.0	2 B 58 SDS	A-2	SDS	2	1/16	11/16	1-3/8	5/16	3.2
1 B 60 SDS	5.6	6.0	6.35	C-1	SDS	2	5/16	5/16	1-3/8	3/16	2.1	2 B 60 SDS	A-2	SDS	2	1/16	11/16	1-3/8	5/16	3.4
1 B 62 SDS	5.8	6.2	6.55	C-2	SDS	2	5/16	5/16	1-3/8	3/16	2.2	2 B 62 SDS	A-2	SDS	2	1/16	11/16	1-3/8	5/16	3.5
1 B 64 SDS	6.0	6.4	6.75	C-2	SDS	2	5/16	5/16	1-3/8	3/16	2.3	2 B 64 SDS	A-2	SDS	2	1/16	11/16	1-3/8	5/16	3.6
1 B 66 SDS	6.2	6.6	6.95	C-2	SDS	2	5/16	5/16	1-3/8	3/16	2.4	2 B 66 SDS	A-2	SDS	2	1/16	11/16	1-3/8	5/16	4.1
1 B 68 SDS	6.4	6.8	7.15	C-2	SDS	2	5/16	5/16	1-3/8	3/16	2.5	2 B 68 SDS	A-1	SDS	2	1/16	11/16	1-3/8	5/16	4.3
1 B 70 SDS	6.6	7.0	7.35	C-2	SDS	2	1/2	1/8	1-3/8	1/8	2.7	2 B 70 SK	D-2	SK	2-5/8	1/4	7/16	1-15/16	1/16	4.4
1 B 74 SDS	7.0	7.4	7.75	C-2	SDS	2	1/2	1/8	1-3/8	1/8	2.9	2 B 74 SK	D-2	SK	2-5/8	1/4	7/16	1-15/16	1/16	5.0
1 B 80 SDS	7.6	8.0	8.35	C-3	SDS	2	1/2	1/8	1-3/8	1/8	3.0	2 B 80 SK	D-2	SK	2-5/8	1/4	7/16	1-15/16	1/16	5.4
1 B 86 SDS	8.2	8.6	8.95	C-3	SDS	2	1/2	1/8	1-3/8	1/8	3.2	2 B 86 SK	D-3	SK	2-5/8	1/4	7/16	1-15/16	1/16	5.9
1 B 94 SDS	9.0	9.4	9.75	C-3	SDS	2	1/2	1/8	1-3/8	1/8	3.6	2 B 94 SK	D-3	SK	2-5/8	1/4	7/16	1-15/16	1/16	6.4
1 B 110 SDS	10.6	11.0	11.35	C-3	SDS	2	1/2	1/8	1-3/8	1/8	4.5	2 B 110 SK	D-3	SK	2-5/8	1/4	7/16	1-15/16	1/16	6.8
1 B 124 SDS	12.0	12.4	12.75	C-3	SDS	2	1/2	1/8	1-3/8	1/8	5.4	2 B 124 SK	D-3	SK	2-5/8	1/4	7/16	1-15/16	1/16	7.7
1 B 136 SDS	13.2	13.6	13.95	C-3	SDS	2	1/2	1/8	1-3/8	1/8	6.4	2 B 136 SK	D-3	SK	2-5/8	1/4	7/16	1-15/16	1/16	8.6
1 B 154 SK	15.0	15.4	15.75	C-3	SK	2-5/8	9/16	1/8	1-15/16	3/8	7.7	2 B 154 SK	D-3	SK	2-5/8	1/4	7/16	1-15/16	1/16	10.0
1 B 160 SK	15.6	16.0	16.35	C-3	SK	2-5/8	9/16	1/8	1-15/16	3/8	8.2	2 B 160 SK	D-3	SK	2-5/8	1/4	7/16	1-15/16	1/16	11.3
1 B 184 SK	18.0	18.4	18.75	C-3	SK	2-5/8	9/16	1/8	1-15/16	3/8	9.1	2 B 184 SK	D-3	SK	2-5/8	1/4	7/16	1-15/16	1/16	13.6
1 B 200 SK	19.6	20.0	20.35	C-3	SK	2-5/8	9/16	1/8	1-15/16	3/8	10.4	2 B 200 SF	D-3	SF	2-15/16	5/16	3/8	2-1/16	—	17.7
—	24.6	25.0	25.35	—	—	—	—	—	—	—	—	2 B 250 SF	D-3	SF	2-15/16	5/16	3/8	2-1/16	—	27.7
—	29.6	30.0	30.35	—	—	—	—	—	—	—	—	2 B 300 SF	D-3	SF	2-15/16	5/16	3/8	2-1/16	—	29.0
—	37.6	38.0	38.35	—	—	—	—	—	—	—	—	2 B 380 SF	D-3	SF	2-15/16	5/16	3/8	2-1/16	—	39.0

NOTA: Dimensões em polegadas, peso em kilos. O peso não inclui a bucha. Veja a página B-4 para dimensões adicionais das buchas.

★ As dimensões E e M são nominais, podem variar dependendo das tolerâncias no eixos. As polias tipo E estão unicamente usinadas para a montagem reversa.

A-B Polias QD Convencionais de Canal Combinado em Estoque

Martin

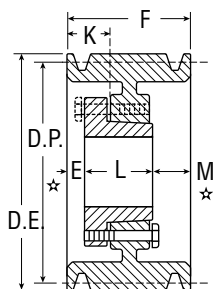

Tipo A

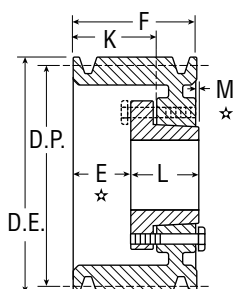

Tipo B

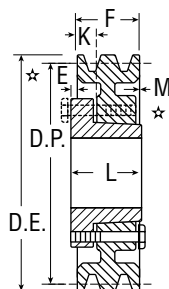

Tipo C

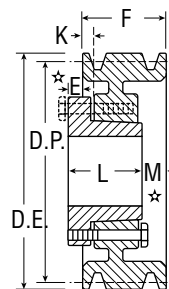

Tipo D

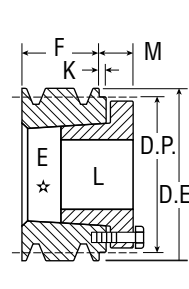

Tipo E

Polias QD – A-B

3 Canais												4 Canais									
F = 2-1/2												F = 3-1/4									
No. de Parte	DP		DE	Tipo	Bucha	Furo Máximo da Bucha	E ★	K	L Compr. Total do Furo	M ★	Peso sem Bucha Kg	No. de parte	Tipo	Bucha	Furo Máximo da Bucha	E ★	K	L Compr. Total do Furo	M ★	Peso sem Bucha Kg	
	Correia A	Correia B																			
3 B 34 SH	3.0	3.4	3.75	E-1	SH	1-11/16	1-3/4	—	1-5/16	9/16	1.5	4 B 34 SD	E-1	SD	2	2-3/8	5/16	1-13/16	15/16	1.8	
3 B 36 SH	3.2	3.6	3.95	D-1	SH	1-11/16	3/8	3/16	1-5/16	1-9/16	1.7	4 B 36 SD	E-1	SD	2	2-3/8	5/16	1-13/16	15/16	2.3	
3 B 38 SH	3.4	3.8	4.15	D-1	SH	1-11/16	3/8	3/16	1-5/16	1-9/16	1.8	4 B 38 SD	E-1	SD	2	2-3/8	5/16	1-13/16	15/16	2.5	
3 B 40 SH	3.6	4.0	4.35	A-1	SH	1-11/16	1/2	1-1/16	1-5/16	11/16	2.0	4 B 40 SD	E-1	SD	2	2-1/16	0	1-13/16	5/8	2.7	
3 B 42 SH	3.8	4.2	4.55	A-1	SH	1-11/16	1/2	1-1/16	1-5/16	11/16	2.3	4 B 42 SD	E-1	SD	2	2-1/16	0	1-13/16	5/8	3.2	
3 B 44 SH	4.0	4.4	4.75	A-1	SH	1-11/16	1/2	1-1/16	1-5/16	11/16	2.5	4 B 44 SD	E-1	SD	2	2-1/16	0	1-13/16	5/8	3.3	
3 B 46 SD	4.2	4.6	4.95	A-1	SD	2	7/16	1-1/16	1-13/16	1/4	2.7	4 B 46 SD	A-1	SD	2	11/16	1-5/16	1-13/16	3/4	3.4	
3 B 48 SD	4.4	4.8	5.15	A-1	SD	2	7/16	1-1/16	1-13/16	1/4	2.9	4 B 48 SD	A-1	SD	2	11/16	1-5/16	1-13/16	3/4	3.6	
3 B 50 SD	4.6	5.0	5.35	A-1	SD	2	7/16	1-1/16	1-13/16	1/4	3.2	4 B 50 SD	A-1	SD	2	11/16	1-5/16	1-13/16	3/4	4.1	
3 B 52 SD	4.8	5.2	5.55	A-1	SD	2	7/16	1-1/16	1-13/16	1/4	3.6	4 B 52 SD	A-1	SD	2	11/16	1-5/16	1-13/16	3/4	4.5	
3 B 54 SD	5.0	5.4	5.75	A-1	SD	2	7/16	1-1/16	1-13/16	1/4	3.9	4 B 54 SD	A-1	SD	2	11/16	1-5/16	1-13/16	3/4	4.8	
3 B 56 SD	5.2	5.6	5.95	A-1	SD	2	7/16	1-1/16	1-13/16	1/4	4.1	4 B 56 SD	A-1	SD	2	11/16	1-5/16	1-13/16	3/4	5.0	
3 B 58 SD	5.4	5.8	6.15	A-1	SD	2	7/16	1-1/16	1-13/16	1/4	4.5	4 B 58 SD	A-1	SD	2	11/16	1-5/16	1-13/16	3/4	5.4	
3 B 60 SD	5.6	6.0	6.35	A-1	SD	2	7/16	1-1/16	1-13/16	1/4	5.0	4 B 60 SD	A-1	SD	2	11/16	1-5/16	1-13/16	3/4	5.7	
3 B 62 SD	5.8	6.2	6.55	A-1	SD	2	7/16	1-1/16	1-13/16	1/4	5.4	4 B 62 SD	A-1	SD	2	11/16	1-5/16	1-13/16	3/4	5.9	
3 B 64 SD	6.0	6.4	6.75	A-1	SD	2	7/16	1-1/16	1-13/16	1/4	5.6	4 B 64 SD	A-1	SD	2	11/16	1-5/16	1-13/16	3/4	6.4	
3 B 66 SD	6.2	6.6	6.95	A-1	SD	2	7/16	1-1/16	1-13/16	1/4	5.7	4 B 66 SD	A-1	SD	2	11/16	1-5/16	1-13/16	3/4	6.6	
3 B 68 SD	6.4	6.8	7.15	A-1	SD	2	7/16	1-1/16	1-13/16	1/4	5.9	4 B 68 SD	A-1	SD	2	11/16	1-5/16	1-13/16	3/4	6.8	
3 B 70 SK	6.6	7.0	7.35	A-1	SK	2-5/8	—	11/16	1-15/16	9/16	6.4	4 B 70 SK	A-1	SK	2-5/8	5/16	1	1-15/16	1	7.0	
3 B 74 SK	7.0	7.4	7.75	A-1	SK	2-5/8	—	11/16	1-15/16	9/16	6.8	4 B 74 SK	A-1	SK	2-5/8	5/16	1	1-15/16	1	7.3	
3 B 80 SK	7.6	8.0	8.35	A-1	SK	2-5/8	—	11/16	1-15/16	9/16	7.3	4 B 80 SK	A-1	SK	2-5/8	5/16	1	1-15/16	1	7.7	
3 B 86 SK	8.2	8.6	8.95	A-3	SK	2-5/8	—	11/16	1-15/16	9/16	7.7	4 B 86 SK	A-3	SK	2-5/8	5/16	1	1-15/16	1	8.2	
3 B 94 SK	9.0	9.4	9.75	A-3	SK	2-5/8	—	11/16	1-15/16	9/16	8.2	4 B 94 SK	A-3	SK	2-5/8	5/16	1	1-15/16	1	8.6	
3 B 110 SK	10.6	11.0	11.35	A-3	SK	2-5/8	—	11/16	1-15/16	9/16	8.6	4 B 110 SK	A-3	SK	2-5/8	5/16	1	1-15/16	1	10.9	
3 B 124 SK	12.0	12.4	12.75	A-3	SK	2-5/8	—	11/16	1-15/16	9/16	10.4	4 B 124 SK	A-3	SK	2-5/8	5/16	1	1-15/16	1	11.8	
3 B 136 SK	13.2	13.6	13.95	A-3	SK	2-5/8	—	11/16	1-15/16	9/16	10.9	4 B 136 SK	A-3	SK	2-5/8	5/16	1	1-15/16	1	12.7	
3 B 154 SK	15.0	15.4	15.75	A-3	SK	2-5/8	—	11/16	1-15/16	9/16	12.7	4 B 154 SF	A-3	SF	2-15/16	5/16	1	2-1/16	7/8	18.6	
3 B 160 SK	15.6	16.0	16.35	A-3	SK	2-5/8	—	11/16	1-15/16	9/16	13.2	4 B 160 SF	A-3	SF	2-15/16	5/16	1	2-1/16	7/8	19.1	
3 B 184 SK	18.0	18.4	18.75	A-3	SK	2-5/8	—	11/16	1-15/16	9/16	16.8	4 B 184 SF	A-3	SF	2-15/16	5/16	1	2-1/16	7/8	21.8	
3 B 200 SF	19.6	20.0	20.35	D-3	SF	2-15/16	1/16	5/8	2-1/16	1/2	17.7	4 B 200 SF	A-3	SF	2-15/16	5/16	1	2-1/16	7/8	26.3	
3 B 250 SF	24.6	25.0	25.35	D-3	SF	2-15/16	1/16	5/8	2-1/16	1/2	30.4	4 B 250 E	A-3	E	3-1/2	1/8	1	2-5/8	1/2	35.4	
3 B 300 SF	29.6	30.0	30.35	D-3	SF	2-15/16	1/16	5/8	2-1/16	1/2	33.6	4 B 300 E	A-3	E	3-1/2	1/8	1	2-5/8	1/2	42.2	
3 B 380 E	37.6	38.0	38.35	D-3	E	3-1/2	1/4	5/8	2-5/8	1/8	55.3	4 B 380 E	A-3	E	3-1/2	1/8	1	2-5/8	1/2	62.6	

NOTA: Dimensões em polegadas, peso em kilos. O peso não inclui a bucha. Veja a página B-4 para dimensões adicionais das buchas.

★ As dimensões E e M são nominais, podem variar dependendo das tolerâncias no eixos. As polias tipo E estão unicamente usinadas para a montagem reversa.

Martin

Polias QD Convencionais de Canal Combinado em Estoque

A-B

 $\frac{1}{2} \times \frac{5}{16}$
A

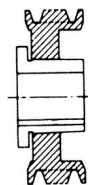
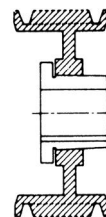
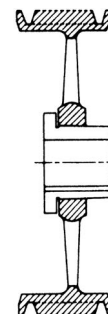
 $\frac{21}{32} \times \frac{13}{32}$
B

1 = Sólida

2 = Alma

3 = Raios

Polias QD – A-B

5 Canais											6 Canais									
F = 4											F = 4-3/4									
No. de Parte	DP		DE	Tipo	Bucha	Furo Máximo da Bucha	E ★	K	L Compr. Total do Furo	M ★	Peso sem Bucha Kg	No. de parte	Tipo	Bucha	Furo Máximo da Bucha	E ★	K	L Compr. Total do Furo	M ★	Peso sem Bucha Kg
	Correia A	Correia B																		
5 B 34 SD	3.0	3.4	3.75	E-1	SD	2	3-1/4	7/16	1-13/16	1-1/16	2.3	6 B 34 SD	E-1	SD	2	3-7/8	5/16	1-13/16	15/16	2.7
5 B 36 SD	3.2	3.6	3.95	E-1	SD	2	3-1/4	7/16	1-13/16	1-1/16	2.7	6 B 36 SD	E-1	SD	2	3-7/8	5/16	1-13/16	13/16	3.2
5 B 38 SD	3.4	3.8	4.15	E-1	SD	2	3-1/8	5/16	1-13/16	15/16	2.9	6 B 38 SD	E-1	SD	2	3-7/8	5/16	1-13/16	13/16	3.4
5 B 40 SD	3.6	4.0	4.35	E-1	SD	2	2-13/16	—	1-13/16	5/8	3.2	6 B 40 SD	E-1	SD	2	3-9/16	—	1-13/16	5/8	3.6
5 B 42 SD	3.8	4.2	4.55	E-1	SD	2	2-13/16	—	1-13/16	5/8	3.4	6 B 42 SD	E-1	SD	2	3-9/16	—	1-13/16	5/8	4.1
5 B 44 SD	4.0	4.4	4.75	E-1	SD	2	2-13/16	—	1-13/16	5/8	3.6	6 B 44 SD	E-1	SD	2	3-9/16	—	1-13/16	5/8	4.3
5 B 46 SD	4.2	4.6	4.95	A-1	SD	2	11/16	1-5/16	1-13/16	1-1/2	4.1	6 B 46 SD	A-1	SD	2	9/16	1-3/16	1-13/16	2-3/8	4.5
5 B 48 SD	4.4	4.8	5.15	A-1	SD	2	11/16	1-5/16	1-13/16	1-1/2	4.3	6 B 48 SD	A-1	SD	2	2-1/4	1-3/16	1-13/16	2-3/8	4.8
5 B 50 SD	4.6	5.0	5.35	A-1	SD	2	11/16	1-5/16	1-13/16	1-1/2	4.5	6 B 50 SD	A-1	SD	2	2-1/4	1-3/16	1-13/16	2-3/8	5.0
5 B 52 SD	4.8	5.2	5.55	A-1	SD	2	11/16	1-5/16	1-13/16	1-1/2	4.8	6 B 52 SD	A-1	SD	2	2-1/4	1-3/16	1-13/16	2-3/8	5.2
5 B 54 SK	5.0	5.4	5.75	A-1	SK	2-5/8	5/8	1-5/16	1-15/16	1-7/16	5.0	6 B 54 SK	A-1	SK	2-5/8	5/8	1-5/16	1-15/16	2-3/16	5.4
5 B 56 SK	5.2	5.6	5.95	A-1	SK	2-5/8	5/8	1-5/16	1-15/16	1-7/16	5.2	6 B 56 SK	A-1	SK	2-5/8	5/8	1-5/16	1-15/16	2-3/16	5.9
5 B 58 SK	5.4	5.8	6.15	A-1	SK	2-5/8	5/8	1-5/16	1-15/16	1-7/16	5.4	6 B 58 SK	A-1	SK	2-5/8	5/8	1-5/16	1-15/16	2-3/16	6.4
5 B 60 SK	5.6	6.0	6.35	A-1	SK	2-5/8	5/8	1-5/16	1-15/16	1-7/16	5.9	6 B 60 SK	A-1	SK	2-5/8	5/8	1-5/16	1-15/16	2-3/16	6.8
5 B 62 SK	5.8	6.2	6.55	A-1	SK	2-5/8	5/8	1-5/16	1-15/16	1-7/16	6.4	6 B 62 SK	A-1	SK	2-5/8	5/8	1-5/16	1-15/16	2-3/16	7.3
5 B 64 SK	6.0	6.4	6.75	A-1	SK	2-5/8	5/8	1-5/16	1-15/16	1-7/16	6.8	6 B 64 SK	A-1	SK	2-5/8	5/8	1-5/16	1-15/16	2-3/16	7.7
5 B 66 SK	6.2	6.6	6.95	A-1	SK	2-5/8	5/8	1-5/16	1-15/16	1-7/16	7.3	6 B 66 SK	A-1	SK	2-5/8	5/8	1-5/16	1-15/16	2-3/16	8.2
5 B 68 SK	6.4	6.8	7.15	A-1	SK	2-5/8	5/8	1-5/16	1-15/16	1-7/16	7.7	6 B 68 SK	A-1	SK	2-5/8	5/8	1-5/16	1-15/16	2-3/16	8.6
5 B 70 SF	6.6	7.0	7.35	A-1	SF	2-15/16	5/8	1-5/16	2-1/16	1-5/16	8.2	6 B 70 SF	A-1	SF	2-15/16	1	1-11/16	2-1/16	1-11/16	8.8
5 B 74 SF	7.0	7.4	7.75	A-1	SF	2-15/16	5/8	1-5/16	2-1/16	1-5/16	9.1	6 B 74 SF	A-1	SF	2-15/16	1	1-11/16	2-1/16	1-11/16	10.0
5 B 80 SF	7.6	8.0	8.35	A-1	SF	2-15/16	5/8	1-5/16	2-1/16	1-5/16	10.4	6 B 80 SF	A-1	SF	2-15/16	1	1-11/16	2-1/16	1-11/16	11.3
5 B 86 SF	8.2	8.6	8.95	A-2	SF	2-15/16	5/8	1-5/16	2-1/16	1-5/16	10.9	6 B 86 SF	A-2	SF	2-15/16	1	1-11/16	2-1/16	1-11/16	12.7
5 B 94 SF	9.0	9.4	9.75	A-2	SF	2-15/16	5/8	1-5/16	2-1/16	1-5/16	11.8	6 B 94 SF	A-2	SF	2-15/16	1	1-11/16	2-1/16	1-11/16	13.2
5 B 110 SF	10.6	11.0	11.35	A-2	SF	2-15/16	5/8	1-5/16	2-1/16	1-5/16	14.5	6 B 110 SF	A-2	SF	2-15/16	1	1-11/16	2-1/16	1-11/16	13.6
5 B 124 SF	12.0	12.4	12.75	A-3	SF	2-15/16	5/8	1-5/16	2-1/16	1-5/16	15.9	6 B 124 SF	A-3	SF	2-15/16	1	1-11/16	2-1/16	1-11/16	18.1
5 B 136 SF	13.2	13.6	13.95	A-3	SF	2-15/16	5/8	1-5/16	2-1/16	1-5/16	16.3	6 B 136 SF	A-3	SF	2-15/16	1	1-11/16	2-1/16	1-11/16	20.4
5 B 154 SF	15.0	15.4	15.75	A-3	SF	2-15/16	5/8	1-5/16	2-1/16	1-5/16	20.9	6 B 154 SF	A-3	SF	2-15/16	1	1-11/16	2-1/16	1-11/16	20.9
5 B 160 SF	15.6	16.0	16.35	A-3	SF	2-15/16	5/8	1-5/16	2-1/16	1-5/16	21.8	6 B 160 SF	A-3	SF	2-15/16	1	1-11/16	2-1/16	1-11/16	22.7
5 B 184 SF	18.0	18.4	18.75	A-3	SF	2-15/16	5/8	1-5/16	2-1/16	1-5/16	22.7	6 B 184 SF	A-3	SF	2-15/16	1	1-11/16	2-1/16	1-11/16	27.2
5 B 200 E	19.6	20.0	20.35	A-3	E	3-1/2	3/8	1-1/4	2-5/8	1	32.7	6 B 200 E	A-3	E	3-1/2	1/2	1-3/8	2-5/8	1-5/8	35.4
5 B 250 E	24.6	25.0	25.35	A-3	E	3-1/2	3/8	1-1/4	2-5/8	1	40.8	6 B 250 E	A-3	E	3-1/2	1/2	1-3/8	2-5/8	1-5/8	44.5
5 B 300 E	29.6	30.0	30.35	A-3	E	3-1/2	3/8	1-1/4	2-5/8	1	49.0	6 B 300 E	A-3	E	3-1/2	1/2	1-3/8	2-5/8	1-5/8	49.4
5 B 380 E	37.6	38.0	38.35	A-3	E	3-1/2	3/8	1-1/4	2-5/8	1	65.8	6 B 380 E	A-3	E	3-1/2	1/2	1-3/8	2-5/8	1-5/8	78.5

NOTA: Dimensões em polegadas, peso em kilos. O peso não inclui a bucha. Veja a página B-4 para dimensões adicionais das buchas.

★ As dimensões E e M são nominais, podem variar dependendo das tolerâncias no eixos. As polias tipo E estão unicamente usinadas para a montagem reversa.

A-B Polias QD Convencionais de Canal Combinado em Estoque

Martin

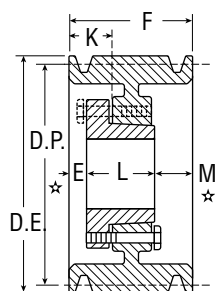

Tipo A

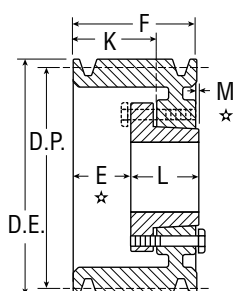

Tipo B

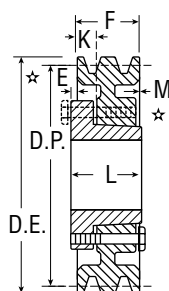

Tipo C

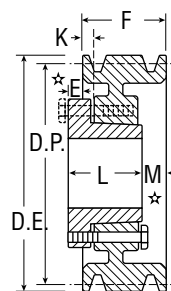

Tipo D

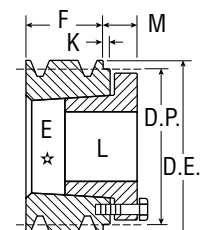

Tipo E



$\frac{1}{2} \times \frac{5}{16}$

A

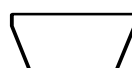

$\frac{21}{32} \times \frac{13}{32}$

B

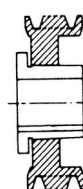

1 = Sólida

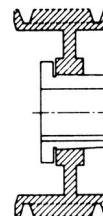

2 = Alma

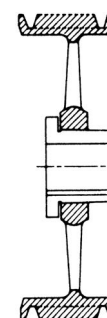

3 = Raios

Polias QD – A-B

8 Canais F = 6-1/4											10 Canais F = 7-3/4									
No. de Parte	DP		DE	Tipo	Buch	Furo Máximo da Bucha	E ★	K	L Compr. Total do Furo	M ★	Peso sem Bucha Kg	No. de parte	Tipo	Buch	Furo Máximo da Bucha	E ★	K	L Compr. Total do Furo	M ★	Peso sem Bucha Kg
	Correia A	Correia B																		
8 B 54 SK	5.0	5.4	5.75	A-1	SK	2-5/8	1-1/8	1-13/16	1-15/16	3-3/16	6.4	10 B 54 SK	A-1	SK	2-5/8	1-7/8	2-9/16	1-15/16	3-15/16	6.8
8 B 56 SK	5.2	5.6	5.95	A-1	SK	2-5/8	1-1/8	1-13/16	1-15/16	3-3/16	7.3	10 B 56 SK	A-1	SK	2-5/8	1-7/8	2-9/16	1-15/16	3-15/16	8.2
8 B 58 SK	5.4	5.8	6.15	A-1	SK	2-5/8	1-1/8	1-13/16	1-15/16	3-3/16	7.5	10 B 58 SK	A-1	SK	2-5/8	1-7/8	2-9/16	1-15/16	3-15/16	9.1
8 B 60 SF	5.6	6.0	6.35	A-1	SF	2-15/16	1-1/8	1-13/16	2-1/16	3-1/16	7.7	10 B 60 SF	A-1	SF	2-15/16	1-7/8	2-9/16	2-1/16	3-13/16	10.0
8 B 62 SF	5.8	6.2	6.55	A-1	SF	2-15/16	1-1/8	1-13/16	2-1/16	3-1/16	8.2	10 B 62 SF	A-1	SF	2-15/16	1-7/8	2-9/16	2-1/16	3-13/16	10.9
8 B 64 SF	6.0	6.4	6.75	A-1	SF	2-15/16	1-1/8	1-13/16	2-1/16	3-1/16	8.4	10 B 64 SF	A-1	SF	2-15/16	1-7/8	2-9/16	2-1/16	3-13/16	11.3
8 B 66 SF	6.2	6.6	6.95	A-1	SF	2-15/16	1-1/8	1-13/16	2-1/16	3-1/16	9.5	10 B 66 SF	A-1	SF	2-15/16	1-7/8	2-9/16	2-1/16	3-13/16	11.8
8 B 68 SF	6.4	6.8	7.15	A-1	SF	2-15/16	1-1/8	1-13/16	2-1/16	3-1/16	10.0	10 B 68 SF	A-1	SF	2-15/16	1-7/8	2-9/16	2-1/16	3-13/16	12.2
8 B 70 SF	6.6	7.0	7.35	A-1	SF	2-15/16	1-1/8	1-13/16	2-1/16	3-1/16	10.2	10 B 70 SF	A-1	SF	2-15/16	1-7/8	2-9/16	2-1/16	3-13/16	12.7
8 B 74 SF	7.0	7.4	7.75	A-1	SF	2-15/16	1-1/8	1-13/16	2-1/16	3-1/16	11.3	10 B 74 SF	A-1	SF	2-15/16	1-7/8	2-9/16	2-1/16	3-13/16	14.1
8 B 80 SF	7.6	8.0	8.35	A-1	SF	2-15/16	1-1/8	1-13/16	2-1/16	3-1/16	13.2	10 B 80 SF	A-1	SF	2-15/16	1-7/8	2-9/16	2-1/16	3-13/16	15.9
8 B 86 E	8.2	8.6	8.95	A-1	E	3-1/2	1-1/2	2-3/8	2-5/8	2-1/8	15.4	10 B 86 E	A-1	E	3-1/2	2-1/4	3-1/8	2-5/8	2-7/8	17.2
8 B 94 E	9.0	9.4	9.75	A-1	E	3-1/2	1-1/2	2-3/8	2-5/8	2-1/8	18.1	10 B 94 E	A-1	E	3-1/2	2-1/4	3-1/8	2-5/8	2-7/8	20.4
8 B 110 E	10.6	11.0	11.35	A-2	E	3-1/2	1-1/2	2-3/8	2-5/8	2-1/8	21.3	10 B 110 E	A-2	E	3-1/2	2-1/4	3-1/8	2-5/8	2-7/8	24.0
8 B 124 E	12.0	12.4	12.75	A-3	E	3-1/2	1-1/2	2-3/8	2-5/8	2-1/8	23.6	10 B 124 E	A-3	E	3-1/2	2-1/4	3-1/8	2-5/8	2-7/8	28.6
8 B 136 E	13.2	13.6	13.95	A-3	E	3-1/2	1-1/2	2-3/8	2-5/8	2-1/8	27.2	10 B 136 F	A-3	F	3-15/16	1-1/16	2-1/16	3-5/8	3-1/16	35.4
8 B 154 E	15.0	15.4	15.75	A-3	E	3-1/2	1-1/2	2-3/8	2-5/8	2-1/8	37.2	10 B 154 F	A-3	F	3-15/16	1-1/16	2-1/16	3-5/8	3-1/16	40.8
8 B 160 E	15.6	16.0	16.35	A-3	E	3-1/2	1-1/2	2-3/8	2-5/8	2-1/8	40.8	10 B 160 F	A-3	F	3-15/16	1-1/16	2-1/16	3-5/8	3-1/16	43.5
8 B 184 F	18.0	18.4	18.75	A-3	F	3-15/16	5/16	1-5/16	3-5/8	2-5/16	49.9	10 B 184 F	A-3	F	3-15/16	1-1/16	2-1/16	3-5/8	3-1/16	51.3
8 B 200 F	19.6	20.0	20.35	A-3	F	3-15/16	5/16	1-5/16	3-5/8	2-5/16	55.3	10 B 200 F	A-3	F	3-15/16	1-1/16	2-1/16	3-5/8	3-1/16	51.7
8 B 250 F	24.6	25.0	25.35	A-3	F	3-15/16	5/16	1-5/16	3-5/8	2-5/16	62.6	10 B 250 F	A-3	F	3-15/16	1-1/16	2-1/16	3-5/8	3-1/16	62.6
8 B 300 F	29.6	30.0	30.35	A-3	F	3-15/16	5/16	1-5/16	3-5/8	2-5/16	76.2	10 B 300 F	A-3	F	3-15/16	1-1/16	2-1/16	3-5/8	3-1/16	90.7
8 B 380 F	37.6	38.0	38.35	A-3	F	3-15/16	5/16	1-5/16	3-5/8	2-5/16	100.7	10 B 380 J	A-3	J	4-1/2	3/8	1-9/16	4-1/2	2-7/8	126.6

NOTA: Dimensões em polegadas, peso em kilos. O peso não inclui a bucha. Veja a página B-4 para dimensões adicionais das buchas.

★ As dimensões E e M são nominais, podem variar dependendo das tolerâncias no eixos. As polias tipo E estão unicamente usinadas para a montagem reversa.

Martin

Polias QD Convencionais em Estoque

C

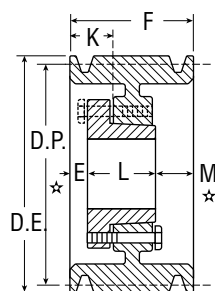

Tipo A

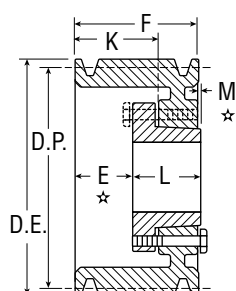

Tipo B

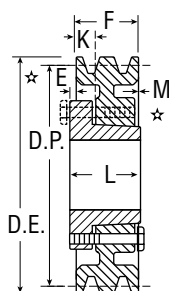

Tipo C

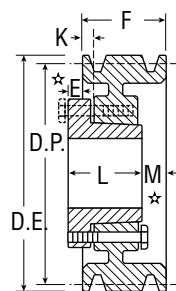

Tipo D

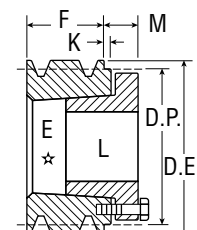

Tipo E

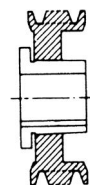

1 = Sólida

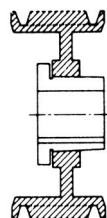

2 = Alma

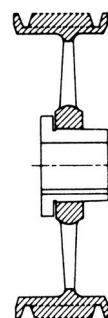

3 = Raios

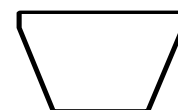

7/8 x 17/32

C

Polias QD – C

1 Canal										2 Canais									
F = 1-3/8										F = 2-3/8									
No. de Parte	DP Correia C	DE	Tipo	Bucha	Furo Máximo da Bucha	E *	K	L Compr. Total do Furo	M *	Peso sem Bucha Kg	No. de parte	Tipo	Bucha	Furo Máximo da Bucha	E *	K	L Compr. Total do Furo	M *	Peso sem Bucha Kg
1 C 60 SK	6.00	6.40	C-1	SK	2-5/8	9/16	1/8	1-15/16	—	4.3	2 C 60 SF	A-1	SF	2-15/16	3/16	7/8	2-1/16	1/8	3.6
1 C 70 SF	7.00	7.40	C-1	SF	2-15/16	9/16	1/8	2-1/16	1/8	4.4	2 C 70 SF	A-1	SF	2-15/16	1/8	13/16	2-1/16	3/16	5.4
1 C 75 SF	7.50	7.90	C-1	SF	2-15/16	9/16	1/8	2-1/16	1/8	5.0	2 C 75 SF	A-1	SF	2-15/16	1/8	13/16	2-1/16	3/16	6.8
1 C 80 SF	8.00	8.40	C-1	SF	2-15/16	9/16	1/8	2-1/16	1/8	5.9	2 C 80 SF	A-1	SF	2-15/16	1/8	13/16	2-1/16	3/16	7.3
1 C 85 SF	8.50	8.90	C-1	SF	2-15/16	9/16	1/8	2-1/16	1/8	6.0	2 C 85 SF	A-2	SF	2-15/16	1/8	13/16	2-1/16	3/16	8.6
1 C 90 SF	9.00	9.40	C-3	SF	2-15/16	9/16	1/8	2-1/16	1/8	6.1	2 C 90 SF	A-2	SF	2-15/16	1/8	13/16	2-1/16	3/16	8.8
1 C 95 SF	9.50	9.90	C-3	SF	2-15/16	9/16	1/8	2-1/16	1/8	6.3	2 C 95 SF	A-2	SF	2-15/16	1/8	13/16	2-1/16	3/16	9.5
1 C 100 SF	10.00	10.40	C-3	SF	2-15/16	9/16	1/8	2-1/16	1/8	6.4	2 C 100 SF	A-2	SF	2-15/16	1/8	13/16	2-1/16	3/16	10.0
1 C 105 SF	10.50	10.90	C-3	SF	2-15/16	9/16	1/8	2-1/16	1/8	6.8	2 C 105 SF	A-2	SF	2-15/16	1/8	13/16	2-1/16	3/16	11.3
1 C 110 SF	11.00	11.40	C-3	SF	2-15/16	9/16	1/8	2-1/16	1/8	7.2	2 C 110 SF	A-3	SF	2-15/16	1/8	13/16	2-1/16	3/16	11.8
1 C 120 SF	12.00	12.40	C-3	SF	2-15/16	9/16	1/8	2-1/16	1/8	7.7	2 C 120 SF	D-3	SF	2-15/16	1/8	9/16	2-1/16	7/16	13.2
1 C 130 SF	13.00	13.40	C-3	SF	2-15/16	9/16	1/8	2-1/16	1/8	8.2	2 C 130 SF	D-3	SF	2-15/16	1/8	9/16	2-1/16	7/16	14.1
1 C 140 SF	14.00	14.40	C-3	SF	2-15/16	9/16	1/8	2-1/16	1/8	9.1	2 C 140 SF	D-3	SF	2-15/16	1/8	9/16	2-1/16	7/16	15.9
1 C 150 SF	15.00	15.40	C-3	SF	2-15/16	9/16	1/8	2-1/16	1/8	9.5	2 C 150 SF	D-3	SF	2-15/16	1/8	9/16	2-1/16	7/16	17.7
1 C 160 SF	16.00	16.40	C-3	SF	2-15/16	9/16	1/8	2-1/16	1/8	10.9	2 C 160 SF	D-3	SF	2-15/16	1/8	9/16	2-1/16	7/16	19.5
1 C 180 SF	18.00	18.40	C-3	SF	2-15/16	9/16	1/8	2-1/16	1/8	12.2	2 C 180 SF	D-3	SF	2-15/16	1/8	9/16	2-1/16	7/16	21.8
1 C 200 SF	20.00	20.40	C-3	SF	2-15/16	9/16	1/8	2-1/16	1/8	14.1	2 C 200 SF	D-3	SF	2-15/16	1/8	9/16	2-1/16	7/16	24.9
1 C 240 SF	24.00	24.40	C-3	SF	2-15/16	9/16	1/8	2-1/16	1/8	16.8	2 C 240 SF	D-3	SF	2-15/16	1/8	9/16	2-1/16	7/16	29.5
—	27.00	27.40	—	—	—	—	—	—	—	—	2 C 270 F	C-3	F	3-15/16	11/16	5/16	3-5/8	9/16	48.5
—	30.00	30.40	—	—	—	—	—	—	—	—	2 C 300 F	C-3	F	3-15/16	11/16	5/16	3-5/8	9/16	52.2

NNOTA: Dimensões em polegadas, peso em kilos. O peso não inclui a bucha. Veja a página B-4 para dimensões adicionais das buchas.

★ As dimensões E e M são nominais, podem variar dependendo das tolerâncias no eixos. As polias tipo E estão unicamente usinadas para a montagem reversa.

C Polias QD Convencionais de Canal Combinado em Estoque



3 Canais										4 Canais									
F = 3-3/8										F = 4-3/8									
No. de Parte	DP Correia C	DE	Tipo	Bucha	Furo Máximo da Bucha	E ★	K	L Compr. Total do Furo	M ★	Peso sem Bucha Kg	No. de parte	Tipo	Bucha	Furo Máximo da Bucha	E ★	K	L Compr. Total do Furo	M ★	Peso sem Bucha Kg
3 C 50 SD	5.00	5.40	A-1	SD	2	5/8	1-1/4	1-13/16	15/16	3.6	4 C 50 SD	A-1	SD	2	5/8	1-1/4	1-13/16	1-15/16	4.5
3 C 54 SD	5.40	5.80	A-1	SD	2	11/16	1-5/16	1-13/16	7/8	4.1	4 C 54 SD	A-1	SD	2	11/16	1-5/16	1-13/16	1-7/8	5.4
3 C 55 SD	5.50	5.90	A-1	SD	2	11/16	1-5/16	1-13/16	7/8	4.5	4 C 55 SD	A-1	SD	2	11/16	1-5/16	1-13/16	1-7/8	5.6
3 C 56 SD	5.60	6.00	A-1	SD	2	11/16	1-5/16	1-13/16	7/8	5.0	4 C 56 SD	A-1	SD	2	11/16	1-5/16	1-13/16	1-7/8	5.6
3 C 60 SF	6.00	6.40	A-1	SF	2-15/16	3/16	7/8	2-1/16	1-1/8	5.4	4 C 60 SF	A-1	SF	2-15/16	3/16	7/8	2-1/16	2-1/8	5.7
3 C 70 SF	7.00	7.40	A-1	SF	2-15/16	5/8	1-5/16	2-1/16	11/16	6.4	4 C 70 SF	A-2	SF	2-15/16	7/8	1-9/16	2-1/16	1-7/16	5.9
3 C 75 SF	7.50	7.90	A-1	SF	2-15/16	5/8	1-5/16	2-1/16	11/16	7.7	4 C 75 SF	A-2	SF	2-15/16	7/8	1-9/16	2-1/16	1-7/16	8.6
3 C 80 E	8.00	8.40	B-1	E	3-1/2	7/8	1-3/4	2-5/8	1/8	8.6	4 C 80 E	A-2	E	3-1/2	1-1/8	2	2-5/8	5/8	10.9
3 C 85 E	8.50	8.90	B-1	E	3-1/2	7/8	1-3/4	2-5/8	1/8	10.0	4 C 85 E	A-1	E	3-1/2	1-1/8	2	2-5/8	5/8	12.2
3 C 90 E	9.00	9.40	B-1	E	3-1/2	7/8	1-3/4	2-5/8	1/8	11.8	4 C 90 E	A-1	E	3-1/2	1-1/8	2	2-5/8	5/8	13.6
3 C 95 E	9.50	9.90	B-1	E	3-1/2	7/8	1-3/4	2-5/8	1/8	13.2	4 C 95 E	A-1	E	3-1/2	1-1/8	2	2-5/8	5/8	15.0
3 C 100 E	10.00	10.40	B-1	E	3-1/2	7/8	1-3/4	2-5/8	1/8	12.2	4 C 100 E	A-1	E	3-1/2	1-1/8	2	2-5/8	5/8	15.9
3 C 105 E	10.50	10.90	B-2	E	3-1/2	7/8	1-3/4	2-5/8	1/8	14.1	4 C 105 E	A-2	E	3-1/2	1-1/8	2	2-5/8	5/8	18.1
3 C 110 E	11.00	11.40	B-2	E	3-1/2	7/8	1-3/4	2-5/8	1/8	17.2	4 C 110 E	A-1	E	3-1/2	1-1/8	2	2-5/8	5/8	20.4
3 C 120 E	12.00	12.40	B-3	E	3-1/2	7/8	1-3/4	2-5/8	1/8	18.1	4 C 120 E	A-1	E	3-1/2	1-1/8	2	2-5/8	5/8	21.8
3 C 130 E	13.00	13.40	B-3	E	3-1/2	7/8	1-3/4	2-5/8	1/8	19.5	4 C 130 E	A-3	E	3-1/2	1-1/8	2	2-5/8	5/8	22.2
3 C 140 E	14.00	14.40	B-3	E	3-1/2	7/8	1-3/4	2-5/8	1/8	20.9	4 C 140 E	A-3	E	3-1/2	1-1/8	2	2-5/8	5/8	25.4
3 C 150 E	15.00	15.40	B-3	E	3-1/2	7/8	1-3/4	2-5/8	1/8	23.6	4 C 150 E	A-3	E	3-1/2	1-1/8	2	2-5/8	5/8	28.1
3 C 160 E	16.00	16.40	B-3	E	3-1/2	7/8	1-3/4	2-5/8	1/8	26.3	4 C 160 E	A-3	E	3-1/2	1-1/8	2	2-5/8	5/8	30.8
3 C 180 E	18.00	18.40	B-3	E	3-1/2	7/8	1-3/4	2-5/8	1/8	30.4	4 C 180 E	A-3	E	3-1/2	1-1/8	2	2-5/8	5/8	33.6
3 C 200 E	20.00	20.40	A-3	E	3-1/2	1/8	1	2-5/8	5/8	31.8	4 C 200 E	A-3	E	3-1/2	5/8	1-1/2	2-5/8	1-1/8	36.7
3 C 240 E	24.00	24.40	A-3	E	3-1/2	1/8	1	2-5/8	5/8	40.8	4 C 240 F	A-3	F	3-15/16	5/16	1-5/16	3-5/8	7/16	54.4
3 C 270 F	27.00	27.40	C-3	F	3-15/16	3/16	13/16	3-5/8	1/16	56.2	4 C 270 F	A-3	F	3-15/16	5/16	1-5/16	3-5/8	7/16	62.6
3 C 300 F	30.00	30.40	C-3	F	3-15/16	3/16	13/16	3-5/8	1/16	59.0	4 C 300 F	A-3	F	3-15/16	5/16	1-5/16	3-5/8	7/16	75.3
3 C 360 F	36.00	36.40	C-3	F	3-15/16	3/16	13/16	3-5/8	1/16	75.3	4 C 360 F	A-3	F	3-15/16	5/16	1-5/16	3-5/8	7/16	79.8
3 C 440 F	44.00	44.40	C-3	F	3-15/16	3/16	13/16	3-5/8	1/16	94.3	4 C 440 J	B-3	J	4-1/2	3/8	1-9/16	4-1/2	1/2	115.2
3 C 500 F	50.00	50.40	C-3	F	3-15/16	3/16	13/16	3-5/8	1/16	113.4	4 C 500 J	B-3	J	4-1/2	3/8	1-9/16	4-1/2	1/2	144.2

5 Canais										6 Canais									
F = 5-3/8										F = 6-3/8									
No. de Parte	DP	DE	Tipo	Bucha	Furo Máximo da Bucha	E ★	K	L Compr. Total do Furo	M ★	Peso sem Bucha Kg	No. de parte	Tipo	Bucha	Furo Máximo da Bucha	E ★	K	L Compr. Total do Furo	M ★	Peso sem Bucha Kg
	Correia C																		
5 C 60 SF	6.00	6.40	A-1	SF	2-15/16	3/8	7/8	2-1/16	3-1/8	6.4	6 C 60 SF	A-1	SF	2-15/16	3/16	7/8	2-1/16	4-1/8	7.3
5 C 70 SF	7.00	7.40	A-1	SF	2-15/16	1-1/4	1-15/16	2-1/16	2-1/16	8.6	6 C 70 SF	A-1	SF	2-15/16	1-1/4	1-15/16	2-1/16	3-1/16	10.0
5 C 75 SF	7.50	7.90	A-1	SF	2-15/16	1-1/4	1-15/16	2-1/16	2-1/16	10.0	6 C 75 SF	A-1	SF	2-15/16	1-1/4	1-15/16	2-1/16	3-1/16	11.3
5 C 80 E	8.00	8.40	A-1	E	3-1/2	1-1/2	2-3/8	2-5/8	1-1/4	12.7	6 C 80 E	A-1	E	3-1/2	1-1/2	2-3/8	2-5/8	2-1/4	14.1
5 C 85 E	8.50	8.90	A-1	E	3-1/2	1-1/2	2-3/8	2-5/8	1-1/4	14.1	6 C 85 E	A-1	E	3-1/2	1-1/2	2-3/8	2-5/8	2-1/4	15.9
5 C 90 E	9.00	9.40	A-1	E	3-1/2	1-1/2	2-3/8	2-5/8	1-1/4	14.5	6 C 90 F	A-1	F	3-15/16	1-7/16	2-7/16	3-5/8	1-5/16	18.1
5 C 95 E	9.50	9.90	A-1	E	3-1/2	1-1/2	2-3/8	2-5/8	1-1/4	16.3	6 C 95 F	A-1	F	3-15/16	1-7/16	2-7/16	3-5/8	1-5/16	20.0
5 C 100 E	10.00	10.40	A-2	E	3-1/2	1-1/2	2-3/8	2-5/8	1-1/4	17.2	6 C 100 F	A-1	F	3-15/16	1-7/16	2-7/16	3-5/8	1-5/16	22.7
5 C 105 E	10.50	10.90	A-2	E	3-1/2	1-1/2	2-3/8	2-5/8	1-1/4	19.5	6 C 105 F	A-1	F	3-15/16	1-7/16	2-7/16	3-5/8	1-5/16	25.4
5 C 110 E	11.00	11.40	A-1	E	3-1/2	1-1/2	2-3/8	2-5/8	1-1/4	22.7	6 C 110 F	A-1	F	3-15/16	1-7/16	2-7/16	3-5/8	1-5/16	27.2
5 C 120 E	12.00	12.40	A-1	E	3-1/2	1-1/2	2-3/8	2-5/8	1-1/4	24.9	6 C 120 F	A-1	F	3-15/16	1-7/16	2-7/16	3-5/8	1-5/16	29.5
5 C 130 E	13.00	13.40	A-3	E	3-1/2	1-1/2	2-3/8	2-5/8	1-1/4	26.3	6 C 130 F	A-3	F	3-15/16	1-7/16	2-7/16	3-5/8	1-5/16	30.4
5 C 140 E	14.00	14.40	A-3	E	3-1/2	1-1/2	2-3/8	2-5/8	1-1/4	27.7	6 C 140 F	A-3	F	3-15/16	1-7/16	2-7/16	3-5/8	1-5/16	34.0
5 C 150 E	15.00	15.40	A-3	E	3-1/2	1-1/2	2-3/8	2-5/8	1-1/4	31.3	6 C 150 F	A-3	F	3-15/16	1-7/16	2-7/16	3-5/8	1-5/16	41.3
5 C 160 E	16.00	16.40	A-3	E	3-1/2	1-1/2	2-3/8	2-5/8	1-1/4	34.0	6 C 160 F	A-3	F	3-15/16	1-7/16	2-7/16	3-5/8	1-5/16	42.2
5 C 180 E	18.00	18.40	A-3	E	3-1/2	1-1/2	2-3/8	2-5/8	1-1/4	38.6	6 C 180 F	A-3	F	3-15/16	1-7/16	2-7/16	3-5/8	1-5/16	48.1
5 C 200 F	20.00	20.40	A-3	F	3-15/16	5/16	1-5/16	3-5/8	1-7/16	49.0	6 C 200 F	A-3	F	3-15/16	15/16	1-15/16	3-5/8	1-13/16	56.7
5 C 240 F	24.00	24.40	A-3	F	3-15/16	5/16	1-5/16	3-5/8	1-7/16	56.2	6 C 240 F	A-3	F	3-15/16	15/16	1-15/16	3-5/8	1-13/16	73.5
5 C 270 F	27.00	27.40	A-3	F	3-15/16	5/16	1-5/16	3-5/8	1-7/16	69.9	6 C 270 J	A-3	J	3-15/16	3/8	1-9/16	4-1/2	1-1/2	86.2
5 C 300 F	30.00	30.40	A-3	F	3-15/16	5/16	1-5/16	3-5/8	1-7/16	78.9	6 C 300 J	A-3	J	4-1/2	3/8	1-9/16	4-1/2	1-1/2	103.9
5 C 360 J	36.00	36.40	A-3	J	4-1/2	3/8	1-9/16	4-1/2	1/2	102.5	6 C 360 J	A-3	J	4-1/2	3/8	1-9/16	4-1/2	1-1/2	122.5
5 C 440 J	44.00	44.40	A-3	J	4-1/2	3/8	1-9/16	4-1/2	1/2	131.1	6 C 440 J	A-3	J	4-1/2	3/8	1-9/16	4-1/2	1-1/2	136.5
5 C 500 J	50.00	50.40	A-3	J	4-1/2	3/8	1-9/16	4-1/2	1/2	143.3	6 C 500 M	B-3	M	5-1/2	1/2	1-15/16	6-3/4	7/8	201.4

Martin

Polias QD Convencionais em Estoque

C

Polias QD – C

8 Canais										10 Canais									
F = 8-3/8										F = 10-3/8									
No. de Parte	DP	DE	Tipo	Buch	Furo Máximo da Bucha	E ★	K	L Compr. Total do Furo	M ★	Peso sem Bucha Kg	No. de parte	Tipo	Buch	Furo Máximo da Bucha	E ★	K	L Compr. Total do Furo	M ★	Peso sem Bucha Kg
	Correia C																		
8 C 70 SF	7.00	7.40	A-1	SF	2-15/16	2-5/16	3	2-1/16	4	15.9	—	—	—	—	—	—	—	—	—
8 C 80 E	8.00	8.40	A-1	E	3-1/2	2-3/8	3-1/4	2-5/8	3-3/8	16.6	10 C 80 E	A-1	E	3-1/2	2-3/8	3-1/4	2-5/8	5-3/8	19.4
8 C 85 E	8.50	8.90	A-1	E	3-1/2	2-3/8	3-1/4	2-5/8	3-3/8	18.6	10 C 85 E	A-1	E	3-1/2	2-3/8	3-1/4	2-5/8	5-3/8	22.0
8 C 90 F	9.00	9.40	A-1	F	3-15/16	2-5/16	3-5/16	3-5/8	2-7/16	22.7	10 C 90 J	A-1	J	4-1/2	2-3/8	3-9/16	4-1/2	3-1/2	24.5
8 C 95 F	9.50	9.90	A-1	F	3-15/16	2-5/16	3-5/16	3-5/8	2-7/16	23.1	10 C 95 J	A-1	J	4-1/2	2-3/8	3-9/16	4-1/2	3-1/2	27.2
8 C 100 F	10.00	10.40	A-1	F	3-15/16	2-5/16	3-5/16	3-5/8	2-7/16	27.2	10 C 100 J	A-1	J	4-1/2	2-3/8	3-9/16	4-1/2	3-1/2	30.8
8 C 105 F	10.50	10.90	A-1	F	3-15/16	2-5/16	3-5/16	3-5/8	2-7/16	30.4	10 C 105 J	A-1	J	4-1/2	2-3/8	3-9/16	4-1/2	3-1/2	34.0
8 C 110 F	11.00	11.40	A-1	F	3-15/16	2-5/16	3-5/16	3-5/8	2-7/16	33.6	10 C 110 J	A-1	J	4-1/2	2-3/8	3-9/16	4-1/2	3-1/2	40.8
8 C 120 F	12.00	12.40	A-1	F	3-15/16	2-5/16	3-5/16	3-5/8	2-7/16	39.5	10 C 120 J	A-1	J	4-1/2	2-3/8	3-9/16	4-1/2	3-1/2	48.1
8 C 130 F	13.00	13.40	A-3	F	3-15/16	2-5/16	3-5/16	3-5/8	2-7/16	42.6	10 C 130 J	A-2	J	4-1/2	2-3/8	3-9/16	4-1/2	3-1/2	49.9
8 C 140 F	14.00	14.40	A-3	F	3-15/16	2-5/16	3-5/16	3-5/8	2-7/16	44.9	10 C 140 J	A-2	J	4-1/2	2-3/8	3-9/16	4-1/2	3-1/2	56.2
8 C 150 F	15.00	15.40	A-2	F	3-15/16	2-5/16	3-5/16	3-5/8	2-7/16	50.3	10 C 150 J	A-2	J	4-1/2	2-3/8	3-9/16	4-1/2	3-1/2	62.6
8 C 160 F	16.00	16.40	A-3	F	3-15/16	2-5/16	3-5/16	3-5/8	2-7/16	50.8	10 C 160 J	A-3	J	4-1/2	2-3/8	3-9/16	4-1/2	3-1/2	63.0
8 C 180 F	18.00	18.40	A-3	F	3-15/16	2-5/16	3-5/16	3-5/8	2-7/16	52.6	10 C 180 J	A-3	J	4-1/2	2-3/8	3-9/16	4-1/2	3-1/2	76.2
8 C 200 J	20.00	20.40	A-3	J	4-1/2	3/8	1-9/16	4-1/2	3-1/2	66.2	10 C 200 J	A-3	J	4-1/2	2-3/8	3-9/16	4-1/2	3-1/2	82.6
8 C 240 J	24.00	24.40	A-3	J	4-1/2	3/8	1-9/16	4-1/2	3-1/2	88.5	10 C 240 M	A-3	M	5-1/2	1/2	1-15/16	6-3/4	3-1/8	123.4
8 C 270 J	27.00	27.40	A-3	J	4-1/2	3/8	1-9/16	4-1/2	3-1/2	98.0	—	—	—	—	—	—	—	—	—
8 C 300 J	30.00	30.40	A-3	J	4-1/2	3/8	1-9/16	4-1/2	3-1/2	121.6	10 C 300 M	A-3	M	5-1/2	1/2	1-15/16	6-3/4	3-1/8	161.0
8 C 360 M	36.00	36.40	A-3	M	5-1/2	1/2	1-15/16	6-3/4	1-1/8	165.1	10 C 360 M	A-3	M	5-1/2	1/2	1-15/16	6-3/4	3-1/8	206.4
8 C 440 M	44.00	44.40	A-3	M	5-1/2	1/2	1-15/16	6-3/4	1-1/8	187.3	10 C 440 M	A-3	M	51/2	1/2	1-15/16	6-3/4	3-1/8	246.8
8 C 500 M	50.00	50.40	A-3	M	5-1/2	1/2	1-15/16	6-3/4	1-1/8	215.0	10 C 500 M	A-3	M	51/2	1/2	1-15/16	6-3/4	3-1/8	282.1

12 Canais										
F = 12-3/8										
No. de Parte	DP	DE	Tipo	Bucha	Furo Máximo da Bucha	E ★	K	L Compr. Total do Furo	M ★	Peso sem Bucha Kg
	Correia C									
12 C 90 J	9.00	9.40	A-1	J	4-1/2	2-7/8	4-1/16	4-1/2	5	28.6
12 C 95 J	9.50	9.90	A-1	J	4-1/2	2-7/8	4-1/16	4-1/2	5	34.0
12 C 100 J	10.00	10.40	A-1	J	4-1/2	2-7/8	4-1/16	4-1/2	5	38.1
12 C 105 J	10.50	10.90	A-1	J	4-1/2	2-7/8	4-1/16	4-1/2	5	39.0
12 C 110 J	11.00	11.40	A-1	J	4-1/2	2-7/8	4-1/16	4-1/2	5	44.0
12 C 120 J	12.00	12.40	A-1	J	4-1/2	2-7/8	4-1/16	4-1/2	5	54.0
12 C 130 J	13.00	13.40	A-2	J	4-1/2	2-7/8	4-1/16	4-1/2	5	56.7
12 C 140 J	14.00	14.40	A-2	J	4-1/2	2-7/8	4-1/16	4-1/2	5	63.0
12 C 150 J	15.00	15.40	A-2	J	4-1/2	2-7/8	4-1/16	4-1/2	5	70.8
12 C 160 J	16.00	16.40	A-3	J	4-1/2	2-7/8	4-1/16	4-1/2	5	79.4
12 C 180 J	18.00	18.40	A-3	J	4-1/2	2-7/8	4-1/16	4-1/2	5	83.9
12 C 200 M	20.00	20.40	A-3	M	5-1/2	1/2	1-15/16	6-3/4	5-1/8	103.4
12 C 240 M	24.00	24.40	A-3	M	5-1/2	1/2	1-15/16	6-3/4	5-1/8	130.2
12 C 300 M	30.00	30.40	A-3	M	5-1/2	1/2	1-15/16	6-3/4	5-1/8	158.8
12 C 360 M	36.00	36.40	A-3	M	5-1/2	1/2	1-15/16	6-3/4	5-1/8	195.0
12 C 440 M	44.00	44.40	A-3	M	5-1/2	1/2	1-15/16	6-3/4	5-1/8	256.3
12 C 500 M	50.00	50.40	A-3	M	5-1/2	1/2	1-15/16	6-3/4	5-1/8	269.9

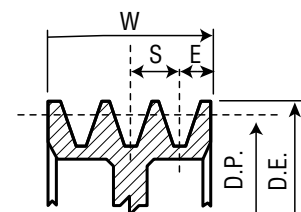

Dimensões dos Canais Combinados

Seção da Correia	E	S	D.E.
C	11/16	1	DP B + .40

$$W = S(N-1) + 2E$$

$$N = \text{No. de Canais}$$

NOTA: Dimensões em polegadas, peso em kilos. O peso não inclui a bucha. Veja a página B-4 para dimensões adicionais das buchas.

D Polias QD Convencionais em Estoque

Martin

Polias QD – D

3 Canais											4 Canais								
F = 4-5/8											F = 6-1/16								
No. de Parte	DP	DE	Tipo	Bucha	Furo Máximo da Bucha	E ★	K	L Compr. Total do Furo	M ★	Peso sem Bucha Kg	No. de parte	Tipo	Bucha	Furo Máximo da Bucha	E ★	K	L Compr. Total do Furo	M ★	Peso sem Bucha Kg
3 D 120 F	12.0	12.6	A-2	F	3-15/16	1/2	1-1/2	3-5/8	1/2	26.3	4 D 120 F	A-2	F	3-15/16	1-5/16	2-5/16	3-5/8	1-1/8	30.8
3 D 130 F	13.0	13.6	A-2	F	3-15/16	1/2	1-1/2	3-5/8	1/2	28.6	4 D 130 F	A-2	F	3-15/16	1-5/16	2-5/16	3-5/8	1-1/8	35.4
3 D 135 F	13.5	14.1	A-2	F	3-15/16	1/2	1-1/2	3-5/8	1/2	30.8	4 D 135 F	A-2	F	3-15/16	1-5/16	2-5/16	3-5/8	1-1/8	37.2
3 D 140 F	14.0	14.6	A-2	F	3-15/16	1/2	1-1/2	3-5/8	1/2	32.2	4 D 140 F	A-2	F	3-15/16	1-5/16	2-5/16	3-5/8	1-1/8	41.3
3 D 145 F	14.5	15.1	A-2	F	3-15/16	1/2	1-1/2	3-5/8	1/2	37.2	4 D 145 F	A-2	F	3-15/16	1-5/16	2-5/16	3-5/8	1-1/8	42.2
3 D 150 F	15.0	15.6	A-2	F	3-15/16	1/2	1-1/2	3-5/8	1/2	39.0	4 D 150 F	A-2	F	3-15/16	1-5/16	2-5/16	3-5/8	1-1/8	44.9
3 D 155 F	15.5	16.1	A-2	F	3-15/16	1/2	1-1/2	3-5/8	1/2	42.2	4 D 155 F	A-2	F	3-15/16	1-5/16	2-5/16	3-5/8	1-1/8	50.3
3 D 160 F	16.0	16.6	A-2	F	3-15/16	1/2	1-1/2	3-5/8	1/2	43.1	4 D 160 F	A-2	F	3-15/16	1-5/16	2-5/16	3-5/8	1-1/8	55.3
–	–	–	–	–	–	–	–	–	–	–	4 D 170 J	A-2	J	4-1/2	1-3/8	2-5/16	4-1/2	3/16	61.7
3 D 180 J	18.0	18.6	A-3	J	4-1/2	–	1-3/16	4-1/2	1/8	47.6	4 D 180 J	A-3	J	4-1/2	1-3/8	2-5/16	4-1/2	3/16	64.0
3 D 200 J	20.0	20.6	A-2	J	4-1/2	–	1-3/16	4-1/2	1/8	67.1	4 D 200 J	A-2	J	4-1/2	3/8	1-9/16	4-1/2	1-3/16	75.7
3 D 220 J	22.0	22.6	A-3	J	4-1/2	–	1-3/16	4-1/2	1/8	74.4	4 D 220 J	A-3	J	4-1/2	3/8	1-9/16	4-1/2	1-3/16	83.0
3 D 270 J	27.0	27.6	A-3	J	4-1/2	–	1-3/16	4-1/2	1/8	81.6	4 D 270 J	A-3	J	4-1/2	3/8	1-9/16	4-1/2	1-3/16	100.7
3 D 330 J	33.0	33.6	A-3	J	4-1/2	–	1-3/16	4-1/2	1/8	88.5	4 D 330 M	B-3	M	5-1/2	1/2	1-15/16	6-3/4	1-3/16	142.9
3 D 400 J	40.0	40.6	A-3	J	4-1/2	–	1-3/16	4-1/2	1/8	117.9	4 D 400 M	B-3	M	5-1/2	1/2	1-15/16	6-3/4	1-3/16	152.9

5 Canais										
F = 7-1/2										
No. de Parte	DP	DE	Tipo	Bucha	Furo Máximo da Bucha	E ★	K	L Compr. Total do Furo	M ★	Peso sem Bucha Kg
5 D 120 F	12.0	12.6	A-2	F	3-15/16	2-1/16	3-1/16	3-5/8	1-13/16	39.5
5 D 130 F	13.0	13.6	A-2	F	3-15/16	2-1/16	3-1/16	3-5/8	1-13/16	39.9
5 D 135 F	13.5	14.1	A-2	F	3-15/16	2-1/16	3-1/16	3-5/8	1-13/16	41.7
5 D 140 F	14.0	14.6	A-2	F	3-15/16	2-1/16	3-1/16	3-5/8	1-13/16	43.5
5 D 145 F	14.5	15.1	A-2	F	3-15/16	2-1/16	3-1/16	3-5/8	1-13/16	50.3
5 D 150 F	15.0	15.6	A-2	F	3-15/16	2-1/16	3-1/16	3-5/8	1-13/16	52.2
5 D 155 F	15.5	16.1	A-2	F	3-15/16	2-1/16	3-1/16	3-5/8	1-13/16	54.9
5 D 160 F	16.0	16.6	A-2	F	3-15/16	2-1/16	3-1/16	3-5/8	1-13/16	58.1
5 D 170 J	17.0	17.6	A-2	J	4-1/2	3/8	1-9/16	4-1/2	2-5/8	61.2
5 D 180 J	18.0	18.6	A-3	J	4-1/2	3/8	1-9/16	4-1/2	2-5/8	67.1
5 D 200 J	20.0	20.6	A-3	J	4-1/2	3/8	1-9/16	4-1/2	2-5/8	83.5
5 D 220 J	22.0	22.6	A-3	J	4-1/2	3/8	1-9/16	4-1/2	2-5/8	91.6
5 D 270 M	27.0	27.6	A-3	M	5-1/2	1/2	1-15/16	6-3/4	1/4	113.4
5 D 330 M	33.0	33.6	A-3	M	5-1/2	1/2	1-15/16	6-3/4	1/4	127.0
5 D 400 M	40.0	40.6	A-3	M	5-1/2	1/2	1-15/16	6-3/4	1/4	172.4

NOTA: Dimensões em polegadas, peso em kilos. O peso não inclui a bucha. Veja a página B-4 para dimensões adicionais das buchas.

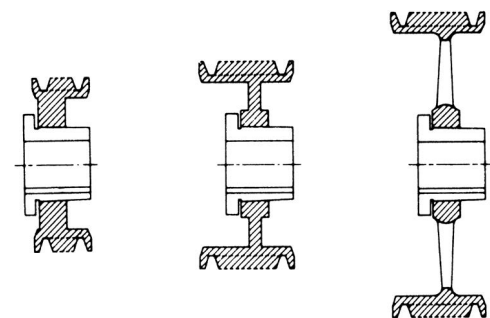

1 = Sólida

2 = Alma

3 = Raios

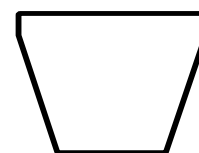

1¼ x ¾

D

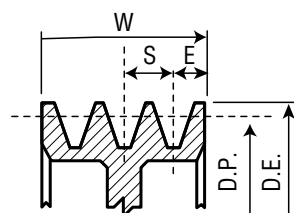

Dimensões dos Canais Combinados

Seção da Correia	E	S	DE
D	7/8	1-7/16	DP B + .60

W = S(N-1) + 2E
N = No. de Canais

Martin

Polias QD Convencionais em Estoque

D

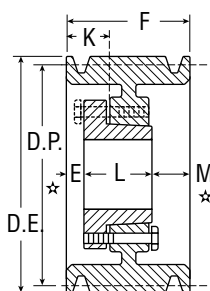

Tipo A

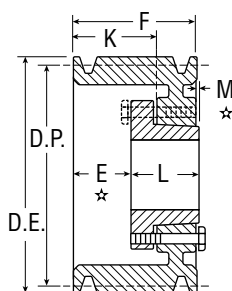

Tipo B

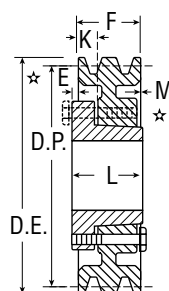

Tipo C

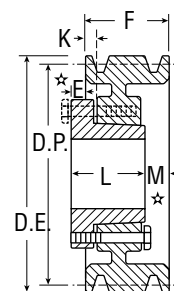

Tipo D

Polias QD – D

6 Canais											8 Canais										
F = 8-15/16											F = 11-13/16										
No. de Parte	DP	DE	Tipo	Bucha	Furo Máximo da Bucha	E ★	K	L Compr. Total do Furo	M ★	Peso sem Bucha Kg	No. de parte	Tipo	Bucha	Furo Máximo da Bucha	E ★	K	L Compr. Total do Furo	M ★	Peso sem Bucha Kg		
	Correia D																				
6 D 120 J	12.00	12.60	A-1	J	4-1/2	2-1/8	3-5/16	4-1/2	2-5/16	47.2	8 D 120 J	A-1	J	4-1/2	2-3/8	3-9/16	4-1/2	4-15/16	57.2		
6 D 130 J	13.00	13.60	A-1	J	4-1/2	2-1/8	3-5/16	4-1/2	2-5/16	55.3	8 D 130 J	A-1	J	4-1/2	2-3/8	3-9/16	4-1/2	4-15/16	66.7		
6 D 135 J	13.50	14.10	A-1	J	4-1/2	2-1/8	3-5/16	4-1/2	2-5/16	56.7	8 D 135 J	A-1	J	4-1/2	2-3/8	3-9/16	4-1/2	4-15/16	68.0		
6 D 140 J	14.00	14.60	A-2	J	4-1/2	2-1/8	3-5/16	4-1/2	2-5/16	58.1	8 D 140 J	A-1	J	4-1/2	2-3/8	3-9/16	4-1/2	4-15/16	70.3		
6 D 145 J	14.50	15.10	A-2	J	4-1/2	2-1/8	3-5/16	4-1/2	2-5/16	59.0	8 D 145 J	A-1	J	4-1/2	2-3/8	3-9/16	4-1/2	4-15/16	72.6		
6 D 150 J	15.00	15.60	A-2	J	4-1/2	2-1/8	3-5/16	4-1/2	2-5/16	61.7	8 D 150 J	A-2	J	4-1/2	2-3/8	3-9/16	4-1/2	4-15/16	79.8		
6 D 155 J	15.50	16.10	A-2	J	4-1/2	2-1/8	3-5/16	4-1/2	2-5/16	63.0	8 D 155 J	A-2	J	4-1/2	2-3/8	3-9/16	4-1/2	4-15/16	81.6		
6 D 160 J	16.00	16.60	A-2	J	4-1/2	2-1/8	3-5/16	4-1/2	2-5/16	64.0	8 D 160 J	A-2	J	4-1/2	2-3/8	3-9/16	4-1/2	4-15/16	90.7		
6 D 170 J	17.00	17.60	A-2	J	4-1/2	2-1/8	3-5/16	4-1/2	2-5/16	69.9	8 D 170 M	A-1	M	5-1/2	2-1/2	3-15/16	6-3/4	2-9/16	102.1		
6 D 180 J	18.00	18.60	A-2	J	4-1/2	2-1/8	3-5/16	4-1/2	2-5/16	78.0	8 D 180 M	A-2	M	5-1/2	2-1/2	3-15/16	6-3/4	2-9/16	113.4		
6 D 200 J	20.00	20.60	A-2	J	4-1/2	2-1/8	3-5/16	4-1/2	2-5/16	83.0	8 D 200 M	A-2	M	5-1/2	2-1/2	3-15/16	6-3/4	2-9/16	122.5		
6 D 220 M	22.00	22.60	A-2	M	5-1/2	1/2	1-15/16	6-3/4	1-11/16	123.4	8 D 220 M	A-2	M	5-1/2	1/2	1-15/16	6-3/4	4-9/16	143.3		
6 D 270 M	27.00	27.60	A-3	M	5-1/2	1/2	1-15/16	6-3/4	1-11/16	127.0	8 D 270 M	A-3	M	5-1/2	1/2	1-15/16	6-3/4	4-9/16	199.6		
6 D 330 M	33.00	33.60	A-3	M	5-1/2	1/2	1-15/16	6-3/4	1-11/16	161.5	8 D 330 M	A-3	M	5-1/2	1/2	1-15/16	6-3/4	4-9/16	207.7		
6 D 400 M	40.00	40.60	A-3	M	5-1/2	1/2	1-15/16	6-3/4	1-11/16	188.2	8 D 400 N	A-3	N	5-1/2	1/2	2-1/4	8-1/8	3-3/16	289.4		
6 D 440 M	44.00	44.60	A-3	M	5-1/2	1/2	1-15/16	6-3/4	1-11/16	243.1	8 D 440 N	A-3	N	6	1/2	2-1/4	8-1/8	3-3/16	279.4		
6 D 480 M	48.00	48.60	A-3	M	5-1/2	1/2	1-15/16	6-3/4	1-11/16	259.5	8 D 480 N	A-3	N	6	1/2	2-1/4	8-1/8	3-3/16	342.5		
6 D 580 N	58.00	58.60	A-3	N	6	1/2	2-1/4	8-1/8	5/16	456.3	8 D 580 N	A-3	N	6	1/2	2-1/4	8-1/8	3-3/16	504.4		

10 Canais											12 Canais									
F = 14-11/16											F = 17-9/16									
No. de Parte	DP	DE	Tipo	Bucha	Furo Máximo da Bucha	E ★	K	L Compr. Total do Furo	M ★	Peso sem Bucha Kg	No. de parte	Tipo	Bucha	Furo Máximo da Bucha	E ★	K	L Compr. Total do Furo	M ★	Peso sem Bucha Kg	
	Correia D																			
10 D 120 M	12.00	12.60	A-1	M	5-1/2	2-1/2	3-15/16	6-3/4	5-7/16	71.7	12 D 120 M	A-1	M	5-1/2	3-1/2	4-15/16	6-3/4	7-5/16	71.7	
10 D 125 M	12.50	13.10	A-1	M	5-1/2	2-1/2	3-15/16	6-3/4	5-7/16	80.7	—	—	—	—	—	—	—	—	—	
10 D 130 M	13.00	13.60	A-1	M	5-1/2	2-1/2	3-15/16	6-3/4	5-7/16	88.9	12 D 130 M	A-1	M	5-1/2	3-1/2	4-15/16	6-3/4	7-5/16	99.3	
10 D 135 M	13.50	14.10	A-1	M	5-1/2	2-1/2	3-15/16	6-3/4	5-7/16	93.9	12 D 135 M	A-1	M	5-1/2	3-1/2	4-15/16	6-3/4	7-5/16	109.8	
10 D 140 M	14.00	14.60	A-1	M	5-1/2	2-1/2	3-15/16	6-3/4	5-7/16	102.1	12 D 140 M	A-1	M	5-1/2	3-1/2	4-15/16	6-3/4	7-5/16	111.6	
10 D 145 M	14.50	15.10	A-1	M	5-1/2	2-1/2	3-15/16	6-3/4	5-7/16	108.0	12 D 145 M	A-1	M	5-1/2	3-1/2	4-15/16	6-3/4	7-5/16	120.7	
10 D 150 M	15.00	15.60	A-1	M	5-1/2	2-1/2	3-15/16	6-3/4	5-7/16	117.9	12 D 150 M	A-1	M	5-1/2	3-1/2	4-15/16	6-3/4	7-5/16	130.2	
10 D 155 M	15.50	16.10	A-1	M	5-1/2	2-1/2	3-15/16	6-3/4	5-7/16	126.6	12 D 155 M	A-1	M	5-1/2	3-1/2	4-15/16	6-3/4	7-5/16	139.7	
10 D 160 M	16.00	16.60	A-1	M	5-1/2	2-1/2	3-15/16	6-3/4	5-7/16	132.4	12 D 160 M	A-1	M	5-1/2	3-1/2	4-15/16	6-3/4	7-5/16	147.4	
10 D 170 M	17.00	17.60	A-1	M	5-1/2	2-1/2	3-15/16	6-3/4	5-7/16	149.7	12 D 170 M	A-1	M	5-1/2	3-1/2	4-15/16	6-3/4	7-5/16	149.7	
10 D 180 M	18.00	18.60	A-1	M	5-1/2	2-1/2	3-15/16	6-3/4	5-7/16	154.2	12 D 180 M	A-1	M	5-1/2	3-1/2	4-15/16	6-3/4	7-5/16	154.2	
10 D 200 M	20.00	20.60	A-2	M	5-1/2	2-1/2	3-15/16	6-3/4	5-7/16	161.0	12 D 200 M	A-2	M	5-1/2	3-1/2	4-15/16	6-3/4	7-5/16	161.0	
10 D 220 M	22.00	22.60	A-3	M	5-1/2	1-1/2	2-15/16	6-3/4	6-7/16	157.9	12 D 220 M	A-2	M	5-1/2	2-1/2	3-15/16	6-3/4	8-5/16	177.8	
10 D 270 M	27.00	27.60	A-3	M	5-1/2	1-1/2	2-15/16	6-3/4	6-7/16	196.9	12 D 270 N	A-3	N	6	2-1/2	4-1/4	6-3/4	6-15/16	229.1	
10 D 330 N	33.00	33.60	A-3	N	6	1-1/2	3-1/4	8-1/8	5-1/16	227.7	12 D 330 N	A-3	N	6	2-1/2	4-1/4	6-3/4	6-15/16	280.8	
10 D 400 N	40.00	40.60	A-3	N	6	1-1/2	3-1/4	8-1/8	5-1/16	329.8	12 D 400 P	A-3	P	6-3/4	5/8	2-5/8	8-1/8	7-9/16	429.1	
10 D 480 P	48.00	48.60	A-3	P	6-3/4	5/8	2-5/8	9-3/8	4-11/16	342.5	12 D 480 P	A-3	P	6-3/4	5/8	2-5/8	8-1/8	7-9/16	523.9	
10 D 580 P	58.00	58.60	A-3	P	6-3/4	5/8	2-5/8	9-3/8	4-11/16	583.3	12 D 580 P	A-3	P	6-3/4	5/8	2-5/8	8-1/8	7-13/16	714.9	